

Snitt A-A

Tegning: Snitt	Målestokk: A3-1:50	Rev.: Dato: 07.09.2017
Prosjekt:		
Tiltakshaver:		
Adresse:		
Kontakt:		
Tegn/konst:		

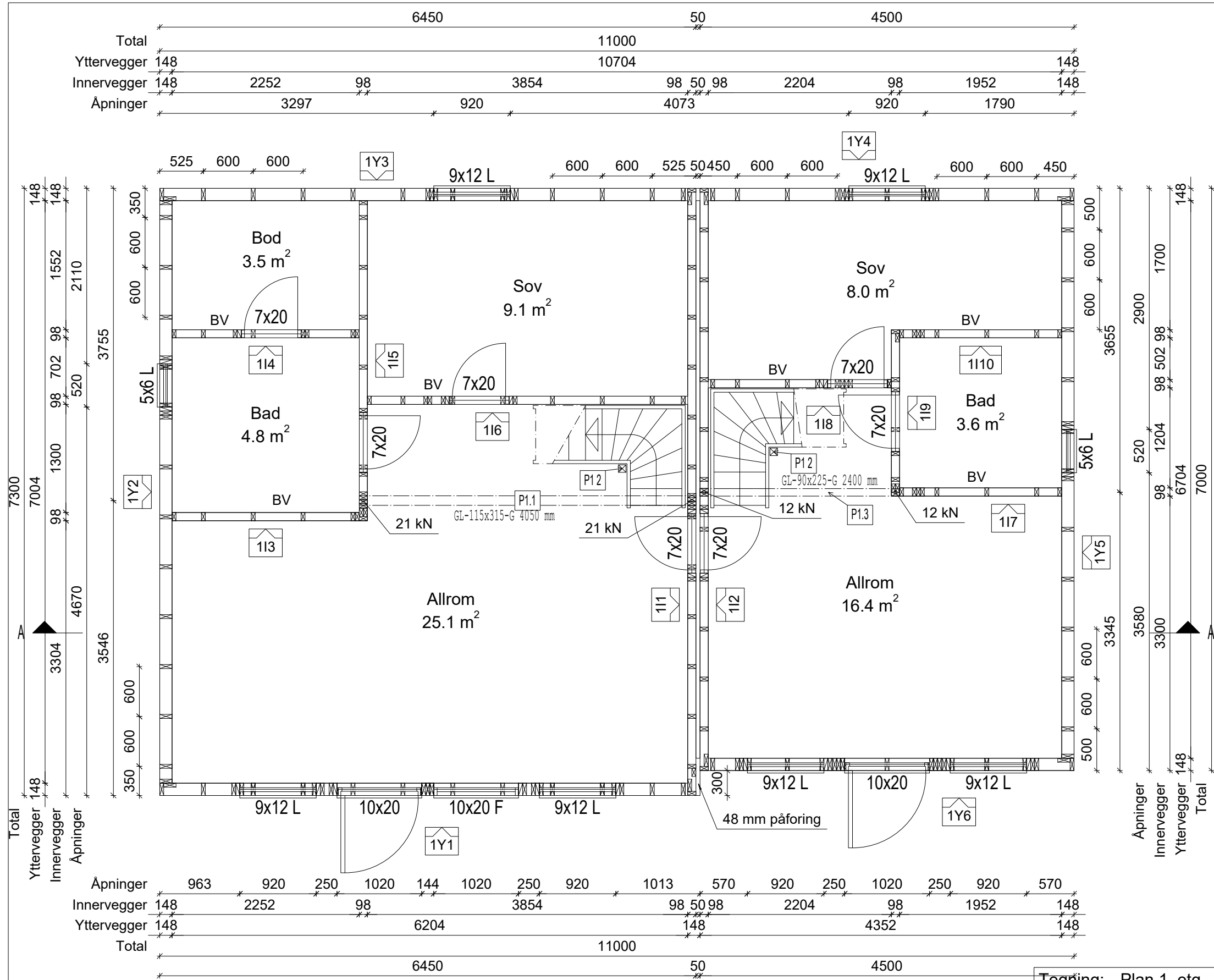

© Tegningene er omfattet av åndsverklovens bestemmelser og er vernet åndsverk i henhold til åndsverkloves paragraf 1. Uten særskilt avtale med Vertex Systems AS er enhver eksemplarfremstilling og tilgjengeliggjøring, i opprinnelig eller endret skikkelse, ulovlig utnyttelse.



ANDRE BJK/SOYLER/DRAGERE				
NR	ANTALL	DIMENSJON	TYPE	LENGDE
P1.1	1	GL-115x315-G	DRAGERE	4050
P1.2	2	GL-90x90-G	SOYLE	2358
P1.3	1	GL-90x225-G	DRAGERE	2400

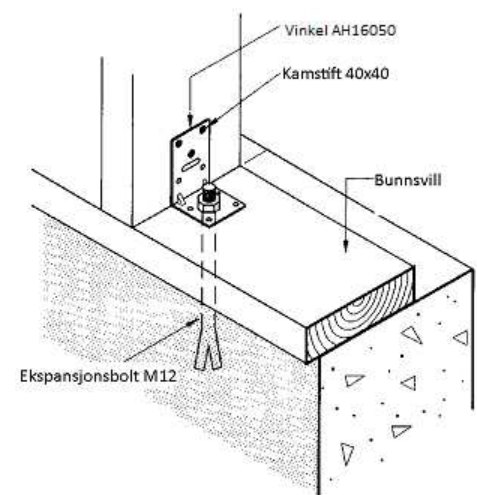

3 stk fra hjørner, deretter c/c 1200.

Tegning: Plan 1. etg.	Målestokk: A3-1:50	Rev.: Dato: 07.09.2017
Prosjekt:		
Tiltakshaver		
Adresse:		
Kontakt:		
Tegn/konst		



© Tegningene er omfattet av åndsverklovens bestemmelser og er vernet åndsverk i henhold til åndsverklovens paragraf 1. Uten særskilt avtale med Vertex Systems AS er enhver eksemplarfremstilling og tilgjengeliggjøring, i opprinnelig eller endret skikkelse, ulovlig utnyttelse.

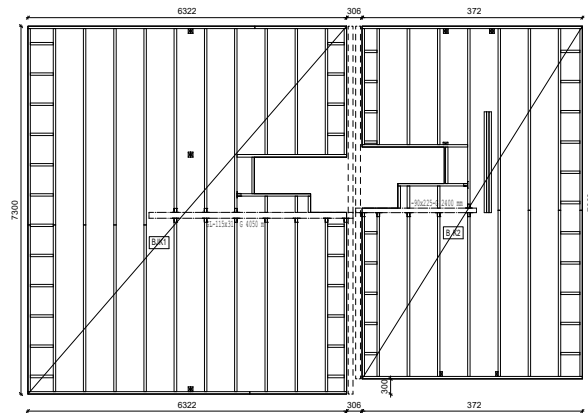
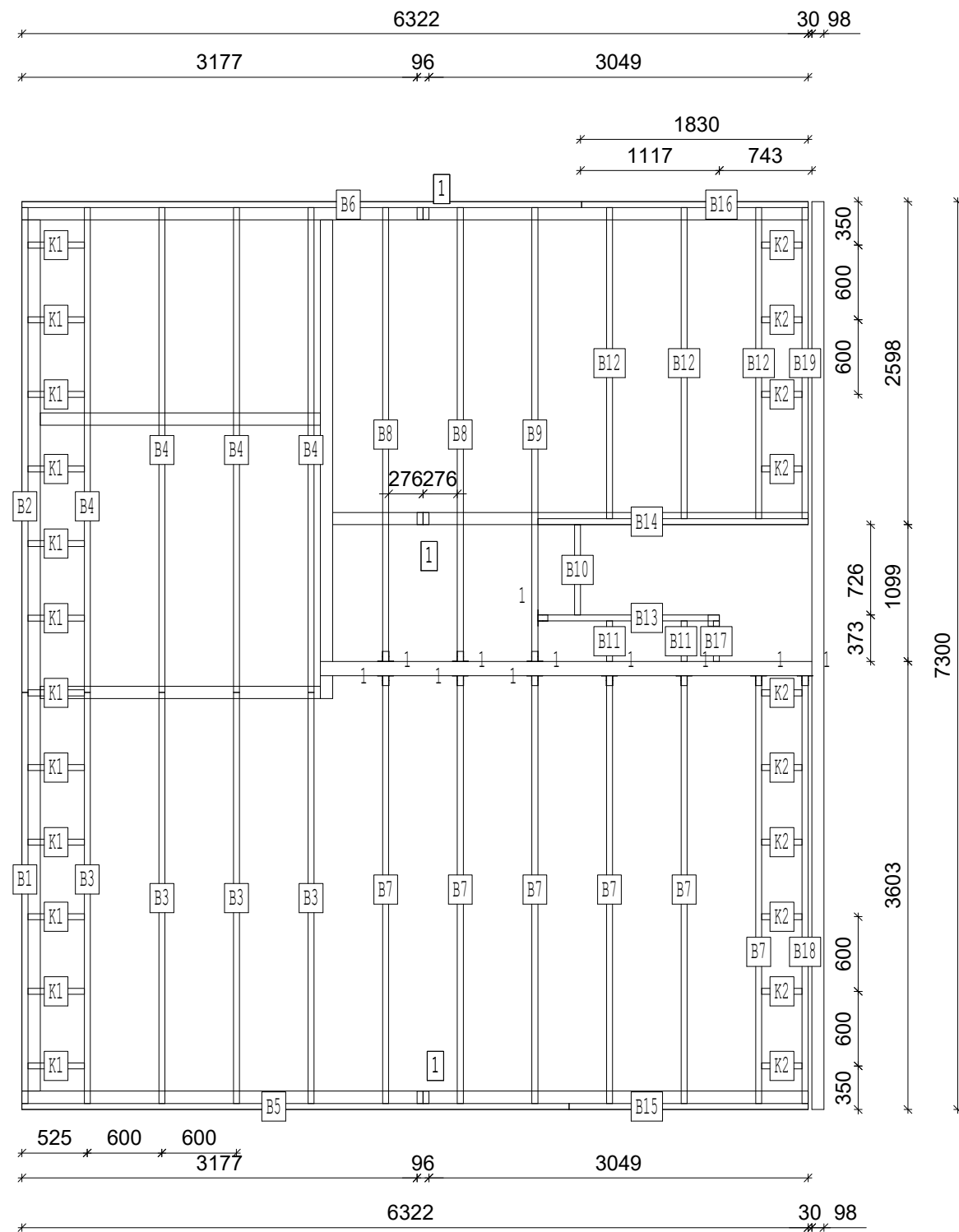

JOIST SCHEDULE					
LABEL	QTY	MATERIAL	GRADE	DESCRIPTION	LENGTH
1	6	48x98 C24	C24	KUBBING	223
B1	1	48x223 C24	C24	KANTBJELKE	3305
B2	1	48x223 C24	C24	KANTBJELKE	3899
B3	4	48x223 C24	C24	BJELKE	3305
B4	4	48x223 C24	C24	BJELKE	3899
B5	1	48x223 C24	C24	KANTBJELKE	4400
B6	1	48x223 C24	C24	KANTBJELKE	4500
B7	6	48x223 C24	C24	BJELKE	3440
B8	2	48x223 C24	C24	BJELKE	3649
B9	1	48x223 C24	C24	KANTBJELKE	3649
B10	1	48x223 C24	C24	BJELKE	725
B11	2	48x223 C24	C24	BJELKE	325
B12	3	48x223 C24	C24	BJELKE	2502
B13	1	48x223 C24	C24	KANTBJELKE	1460
B14	1	48x223 C24	C24	KANTBJELKE	2173
B15	1	48x223 C24	C24	KANTBJELKE	1922
B16	1	48x223 C24	C24	KANTBJELKE	1822
B17	1	48x223 C24	C24	KANTBJELKE	325
B18	1	48x223 C24	C24	KANTBJELKE	3440
B19	1	48x223 C24	C24	KANTBJELKE	2502
K1	12	48x223 C24	C24	KUBBING	453
K2	10	48x223 C24	C24	KUBBING	325

CONNECTOR SCHEDULE			
LABEL	QTY	CODE	NOTE
1	11	7244843 Bjsko u-flik 48x136	-----

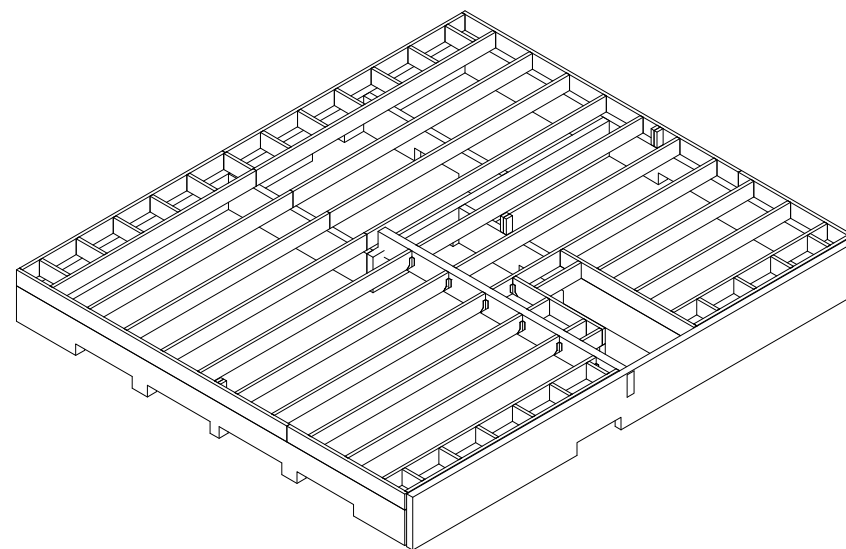

Trappekravel er ikke ihht. til TEK.

Element: BJK1 (Antall: 1)

Prosjekt:

Målestokk:

A3-1:50

Rev.:

Dato: 07.09.2017

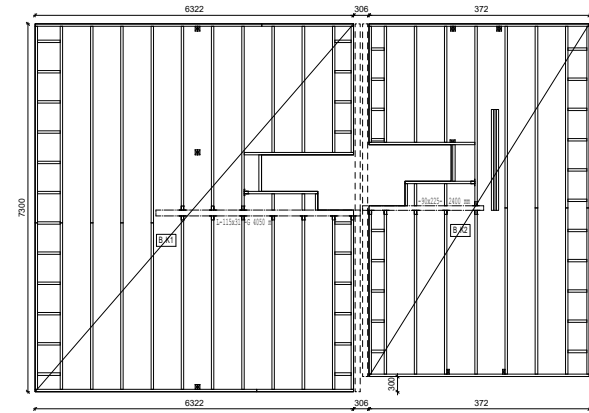
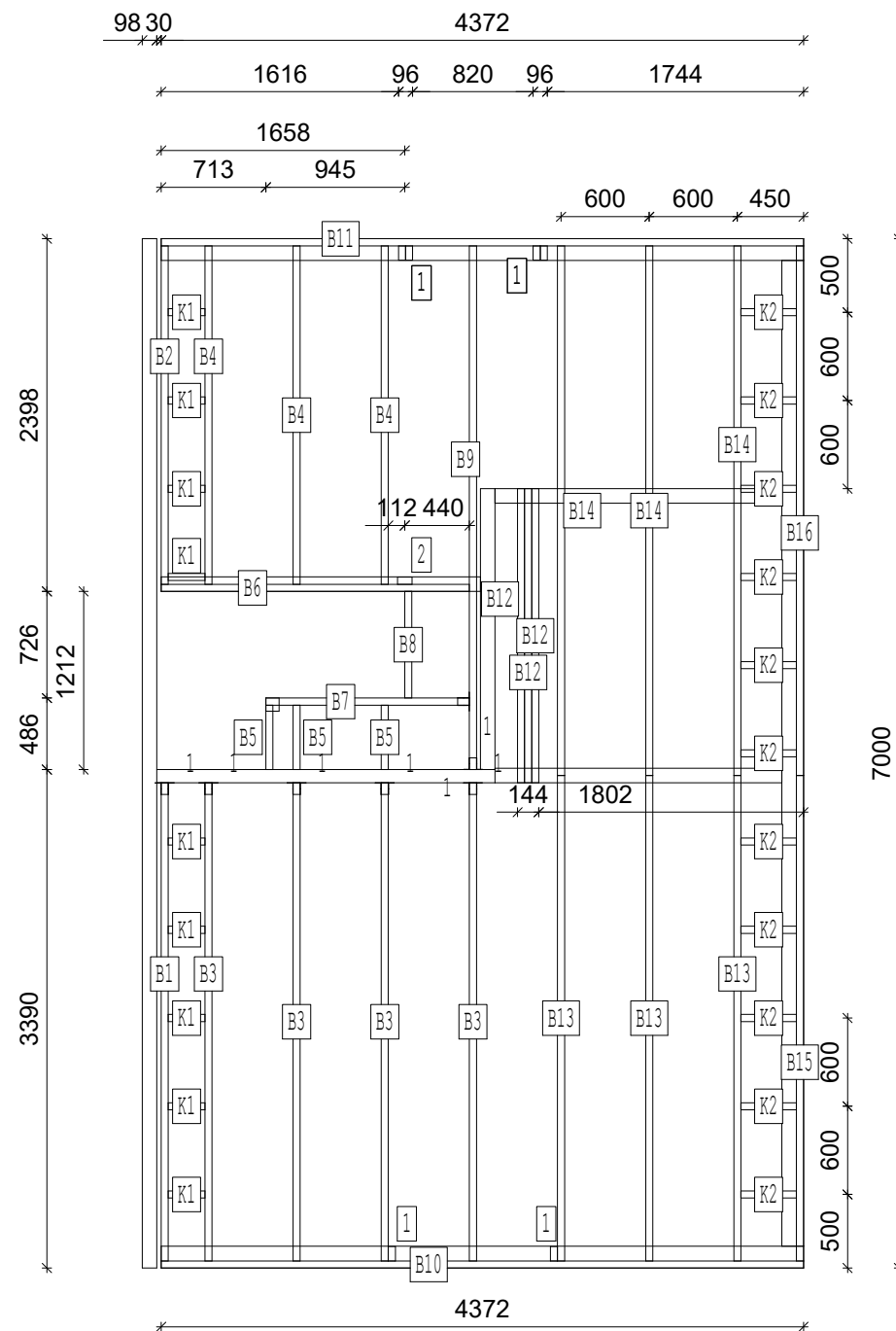

JOIST SCHEDULE					
LABEL	QTY	MATERIAL	GRADE	DESCRIPTION	LENGTH
1	6	48x98 C24	C24	KUBBING	223
2	1	48x98 C24	C24	KUBBING	223
B1	1	48x223 C24	C24	KANTBJELKE	3252
B2	1	48x223 C24	C24	KANTBJELKE	2302
B3	4	48x223 C24	C24	BJELKE	3252
B4	3	48x223 C24	C24	BJELKE	2302
B5	3	48x223 C24	C24	BJELKE	438
B6	1	48x223 C24	C24	KANTBJELKE	2098
B7	1	48x223 C24	C24	KANTBJELKE	1385
B8	1	48x223 C24	C24	KANTBJELKE	725
B9	1	48x223 C24	C24	KANTBJELKE	3562
B10	1	48x223 C24	C24	KANTBJELKE	4372
B11	1	48x223 C24	C24	KANTBJELKE	4372
B12	3	48x223 C24	C24	BJELKE	2000
B13	3	48x223 C24	C24	BJELKE	3301
B14	3	48x223 C24	C24	BJELKE	3603
B15	1	48x223 C24	C24	KANTBJELKE	3301
B16	1	48x223 C24	C24	KANTBJELKE	3603
K1	9	48x223 C24	C24	KUBBING	250
K2	11	48x223 C24	C24	KUBBING	378

CONNECTOR SCHEDULE			
LABEL	QTY	CODE	NOTE
1	7	7244843 Bjsko u-flik 48x136	-----

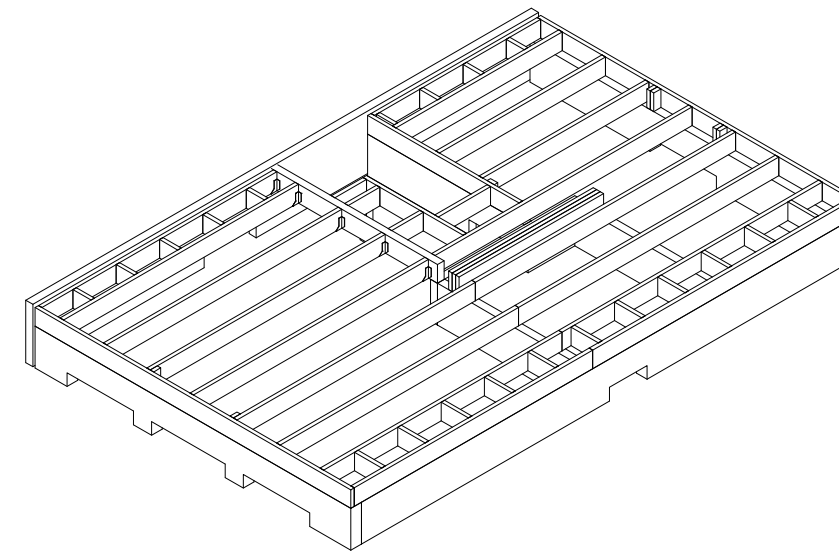

Trappekravel er ikke ihht. til TEK.

Element: BJK2 (Antall: 1)	Målestokk: A3-1:50	Rev.: Dato: 07.09.2017
Prosjekt:		

ANDRE BJK/SOYLER/DRAGERE				
NR	ANTALL	DIMENSJON	TYPE	LENGDE
P2.1	1	GL-115x315-G	DRAGERE	7300
P2.2	1	ST-IPE-100	DRAGERE	900
P2.3	1	GL-115x315-G	DRAGERE	7000

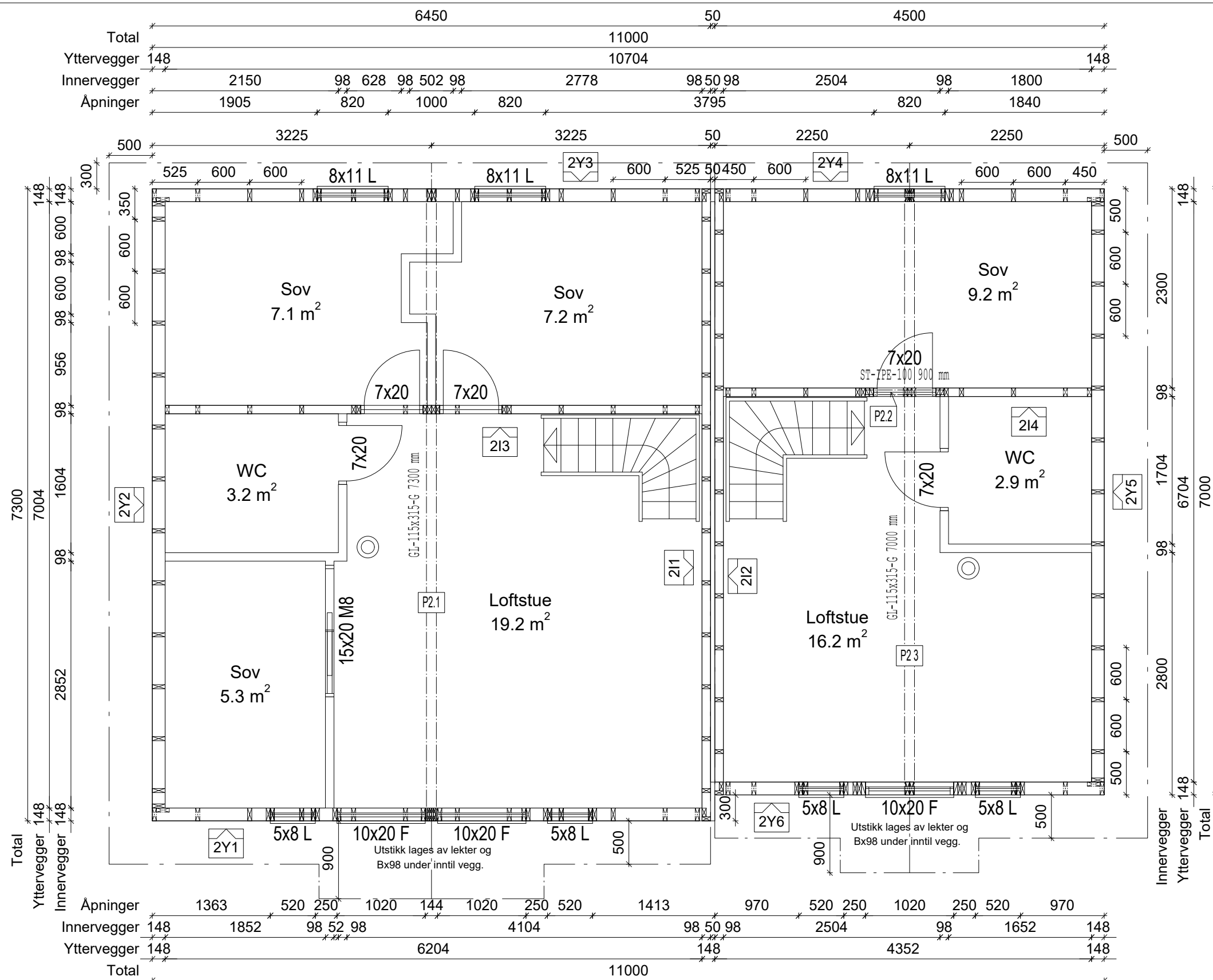

Tegning: Pre-cut plan 2. etg.	Målestokk: A3-1:50	Rev.: Dato: 07.09.2017
Prosjekt: Tiltakshaver Adresse:		
Kontakt: Tegn/konst:		



© Tegningene er omfattet av åndsverklovens bestemmelser og er vernet åndsverk i henhold til åndsverkloves paragraf 1. Uten særskilt avtale med Vertex Systems AS er enhver eksemplarfremstilling og tilgjengeliggjøring, i opprinnelig eller endret skikkelse, ulovlig utnyttelse.

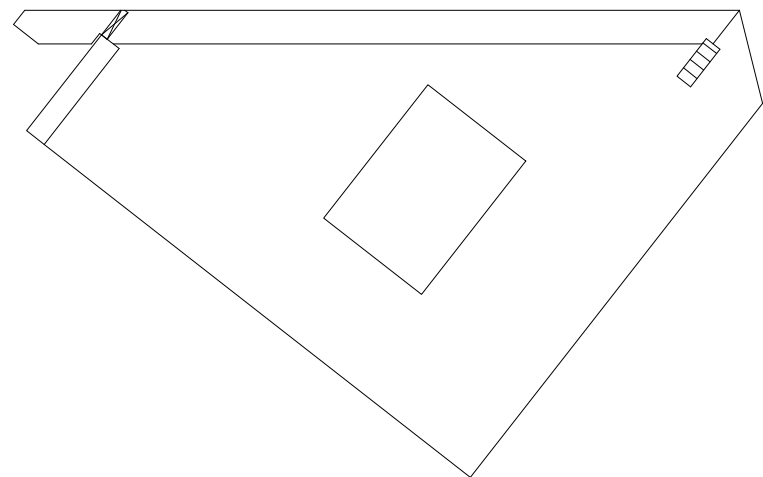
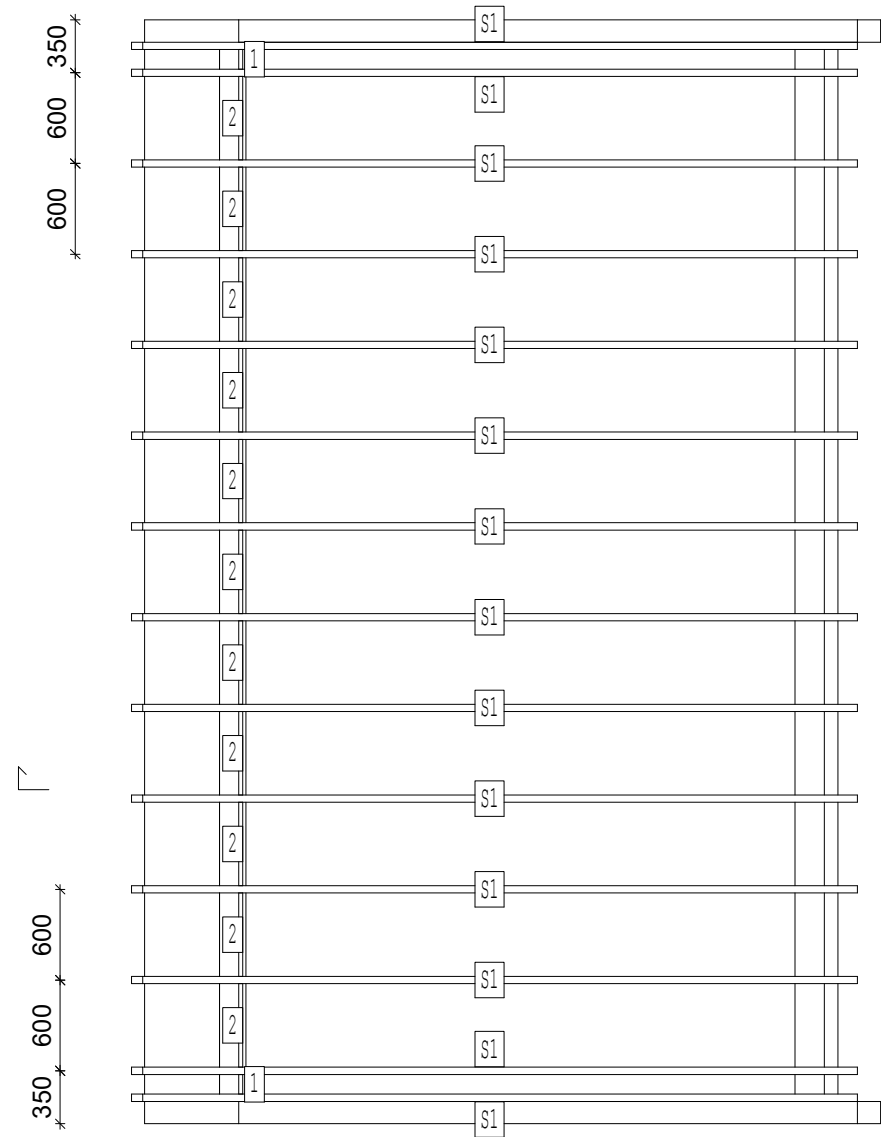

JOIST SCHEDULE					
LABEL	QTY	MATERIAL	GRADE	DESCRIPTION	LENGTH
1	2	48x223 C24	C24	KUBBING	130
2	11	48x223 C24	C24	KUBBING	552
S1	14	48x223 C24	C24	SPERRE	4801

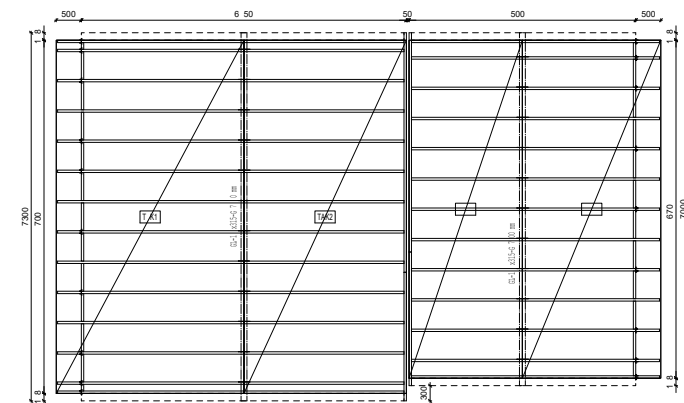

Det benyttes hullplate i mønet mot motstående sperr.
Sperrer forankres til vegg med beslag.

Element: TAK1 (Antall: 1)	Målestokk: A3-1:50	Rev.: Dato: 07.09.2017
Prosjekt:		

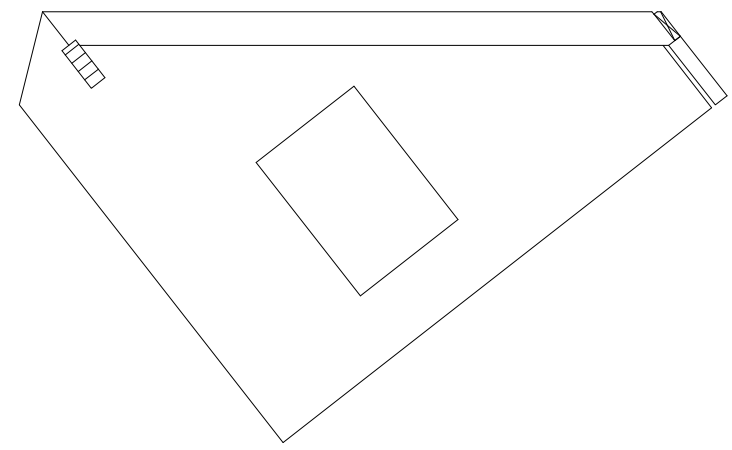
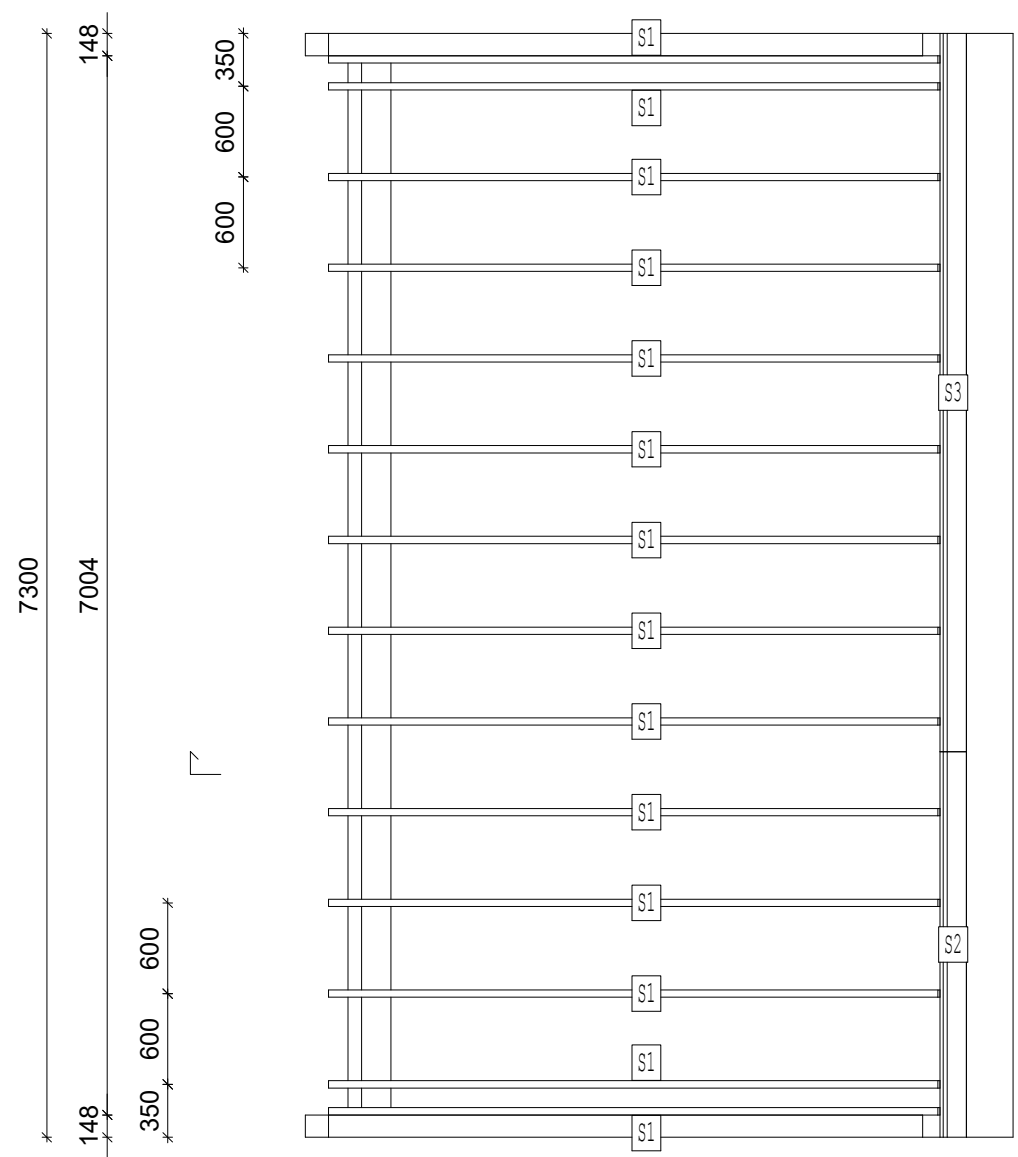

JOIST SCHEDULE					
LABEL	QTY	MATERIAL	GRADE	DESCRIPTION	LENGTH
S1	14	48x223 C24	C24	SPERRE	4182
S2	1	48x223 C24	C24	KANTBJELKE	2550
S3	1	48x223 C24	C24	KANTBJELKE	4750

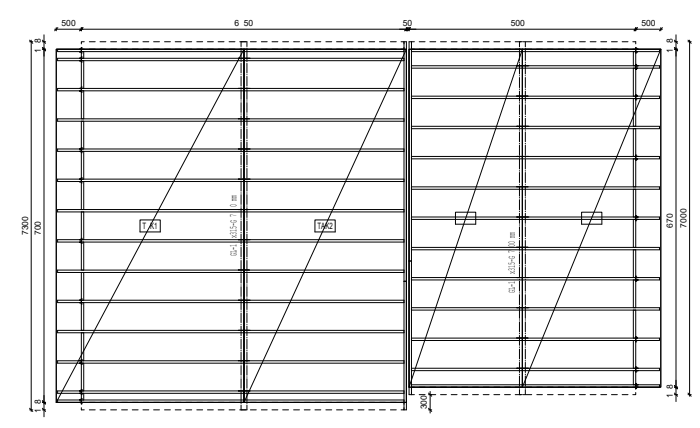

Det benyttes hullplate i mønet mot motstående sperr.

Element: TAK2 (Antall: 1)	Målestokk: A3-1:50	Rev.: Dato: 07.09.2017
Prosjekt:		

JOIST SCHEDULE					
LABEL	QTY	MATERIAL	GRADE	DESCRIPTION	LENGTH
S1	1	48x223 C24	C24	KANTBJELKE	2650
S2	1	48x223 C24	C24	KANTBJELKE	4350
S3	13	48x223 C24	C24	SPERRE	2945

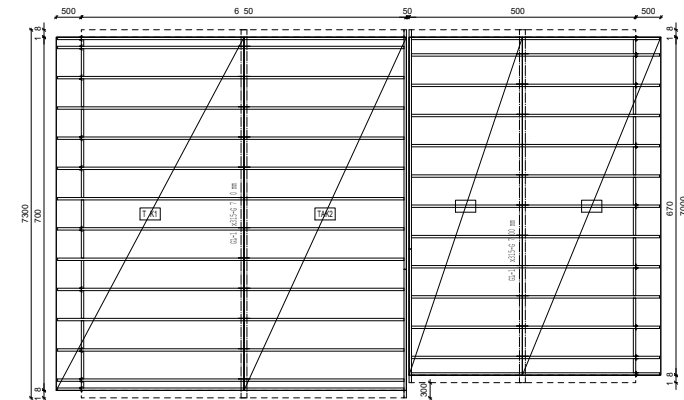
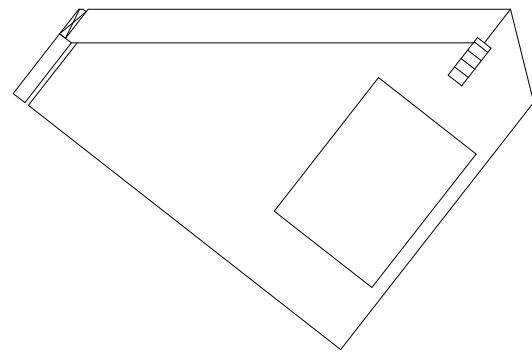
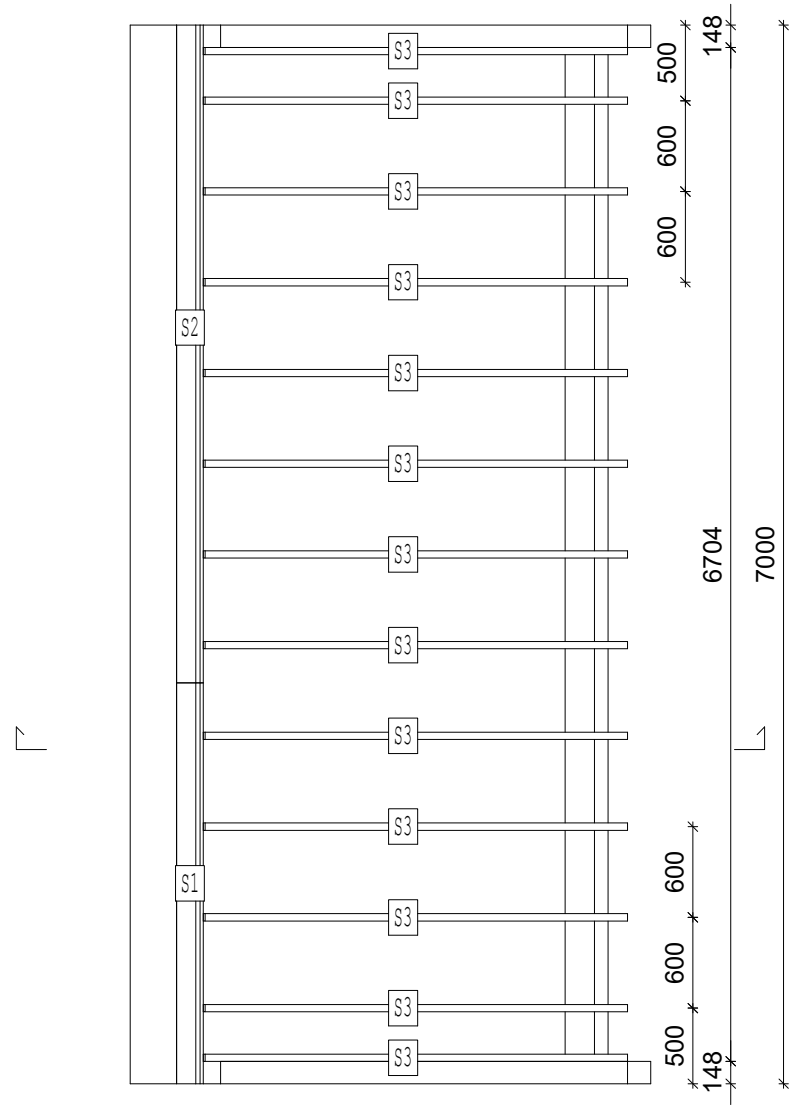

Det benyttes hullplate i mønet mot motstående sperr.

Element: TAK3 (Antall: 1)	Målestokk: A3-1:50	Rev.: Dato: 07.09.2017
Prosjekt:		

JOIST SCHEDULE					
LABEL	QTY	MATERIAL	GRADE	DESCRIPTION	LENGTH
1	2	48x223 C24	C24	KUBBING	280
2	10	48x223 C24	C24	KUBBING	552
S1	13	48x223 C24	C24	SPERRE	3564

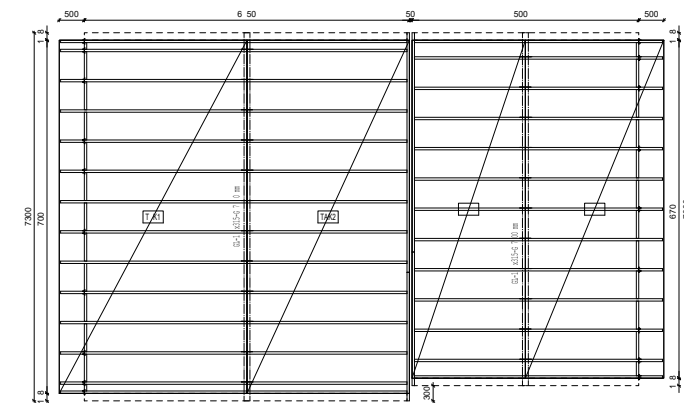
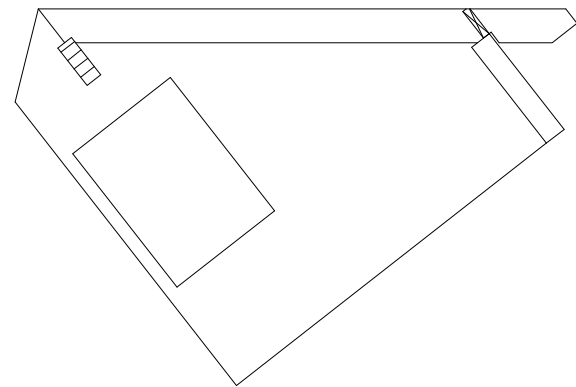
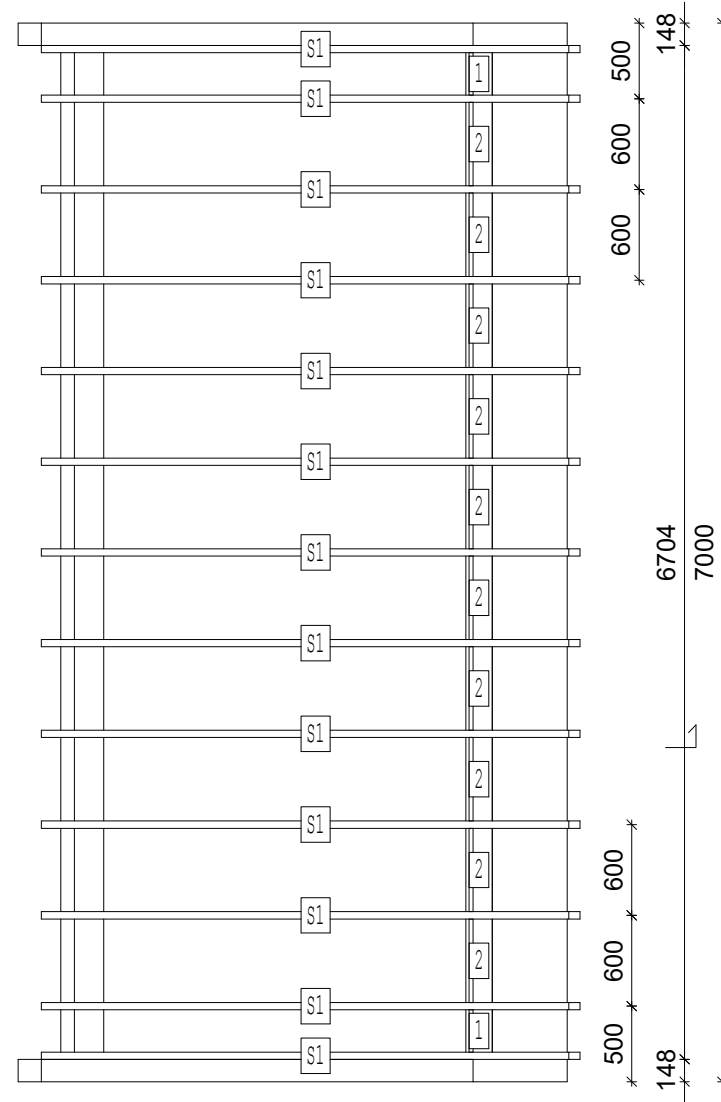

Det benyttes hullplate i mønet mot motstående sperr.
Sperrer forankres til vegger med beslag.

Element: TAK4 (Antall: 1)	Målestokk: A3-1:50	Rev.: Dato: 07.09.2017
Prosjekt:		

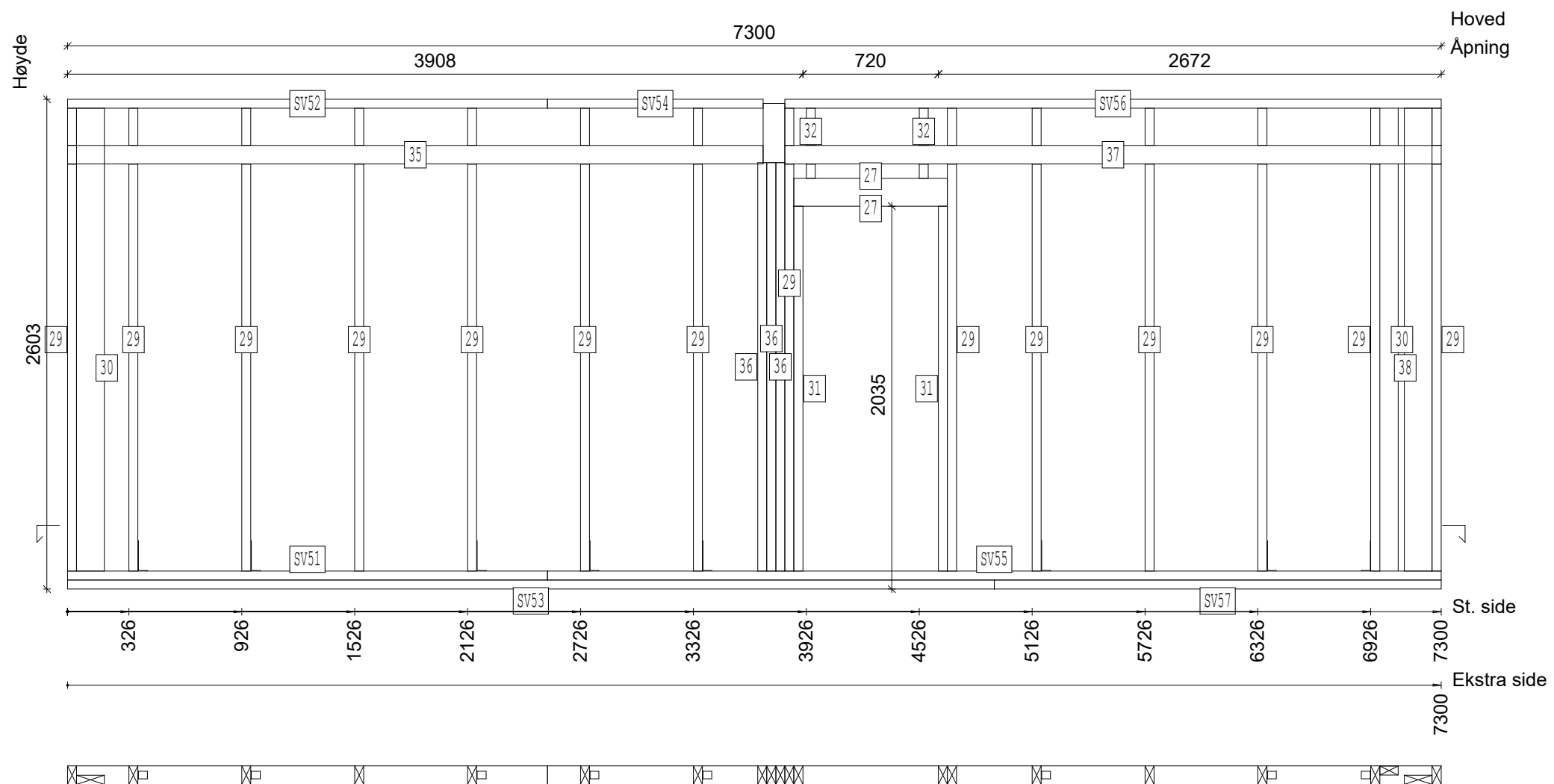

SVILLER				
LABEL	ANT	MATERIAL	TYPE	LENGDE
SV51	1	48x98 C16	BUNNSVILL	2550
SV52	1	48x98 C16	TOPPSVILL	2550
SV53	1	48x98 C16	BUNNSVILL	4925
SV54	1	48x98 C16	TOPPSVILL	1147
SV55	1	48x98 C16	BUNNSVILL	4750
SV56	1	48x98 C16	TOPPSVILL	3488
SV57	1	48x98 C16	BUNNSVILL	2375

KAPPELISTE				
LABEL	ANT	MATERIAL	TYPE	LENGDE
27	2	48x148 C24	LOSHOLT	816
29	14	48x98 C24	STENDER	2459
30	2	48x148 C24	STENDER	2459
31	2	48x98 C24	KRYKKE	1939
32	2	48x98 C24	STENDER	372
35	1	23x98 C16	SPIKERSLAG	3697
36	3	48x98 C24	STENDER	2170
37	1	23x98 C16	SPIKERSLAG	3488
38	1	48x98 C24	STENDER	2459

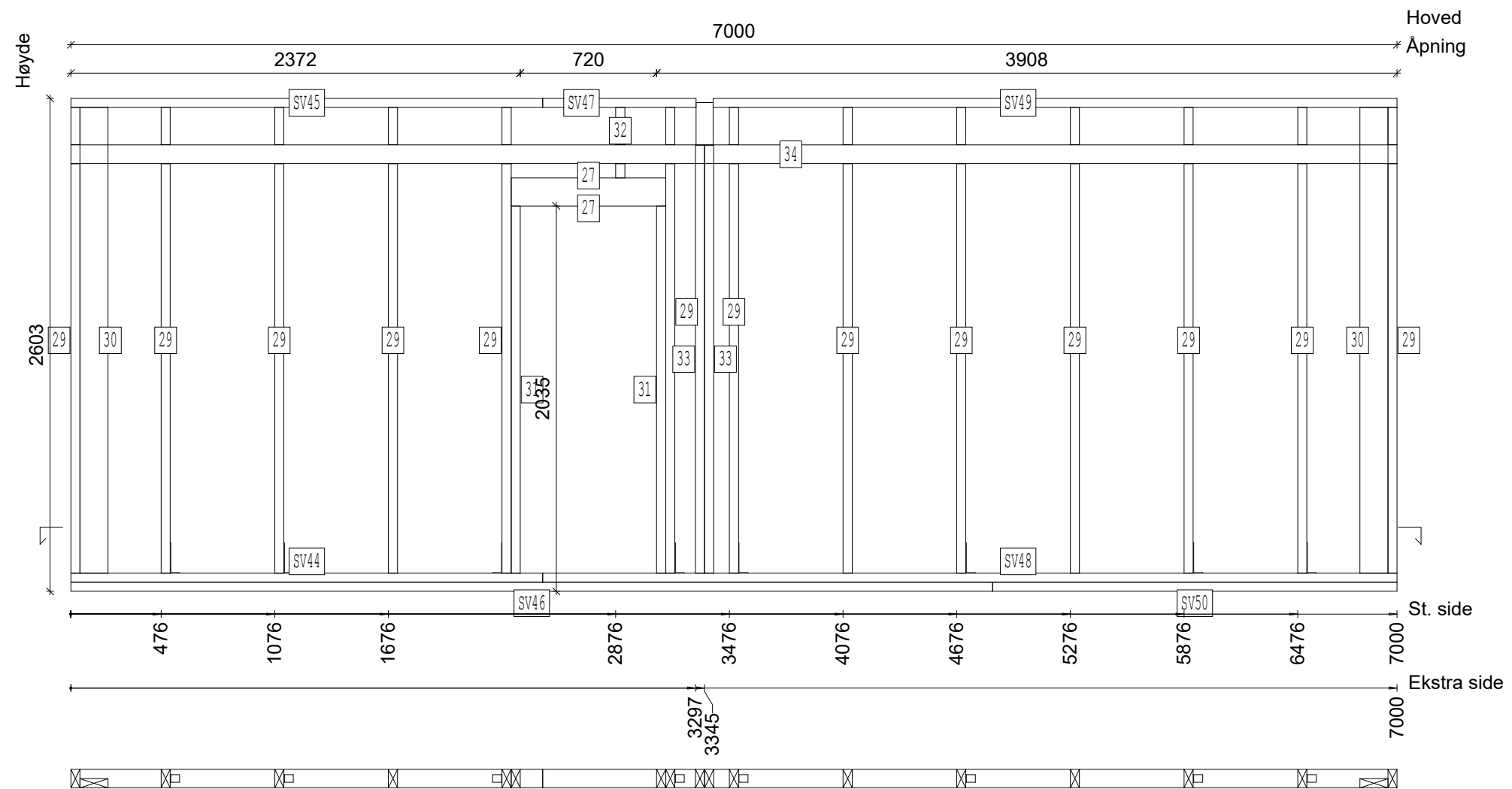

SVILLER				
LABEL	ANT	MATERIAL	TYPE	LENGDE
SV44	1	48x98 C16	BUNNSVILL	2490
SV45	1	48x98 C16	TOPPSVILL	2490
SV46	1	48x98 C16	BUNNSVILL	4865
SV47	1	48x98 C16	TOPPSVILL	810
SV48	1	48x98 C16	BUNNSVILL	4510
SV49	1	48x98 C16	TOPPSVILL	3610
SV50	1	48x98 C16	BUNNSVILL	2135

KAPPELISTE				
LABEL	ANT	MATERIAL	TYPE	LENGDE
27	2	48x148 C24	LOSHOLT	816
29	13	48x98 C24	STENDER	2459
30	2	48x148 C24	STENDER	2459
31	2	48x98 C24	KRYKKE	1939
32	1	48x98 C24	STENDER	372
33	2	48x98 C24	STENDER	2260
34	1	23x98 C16	SPIKERSLAG	7000

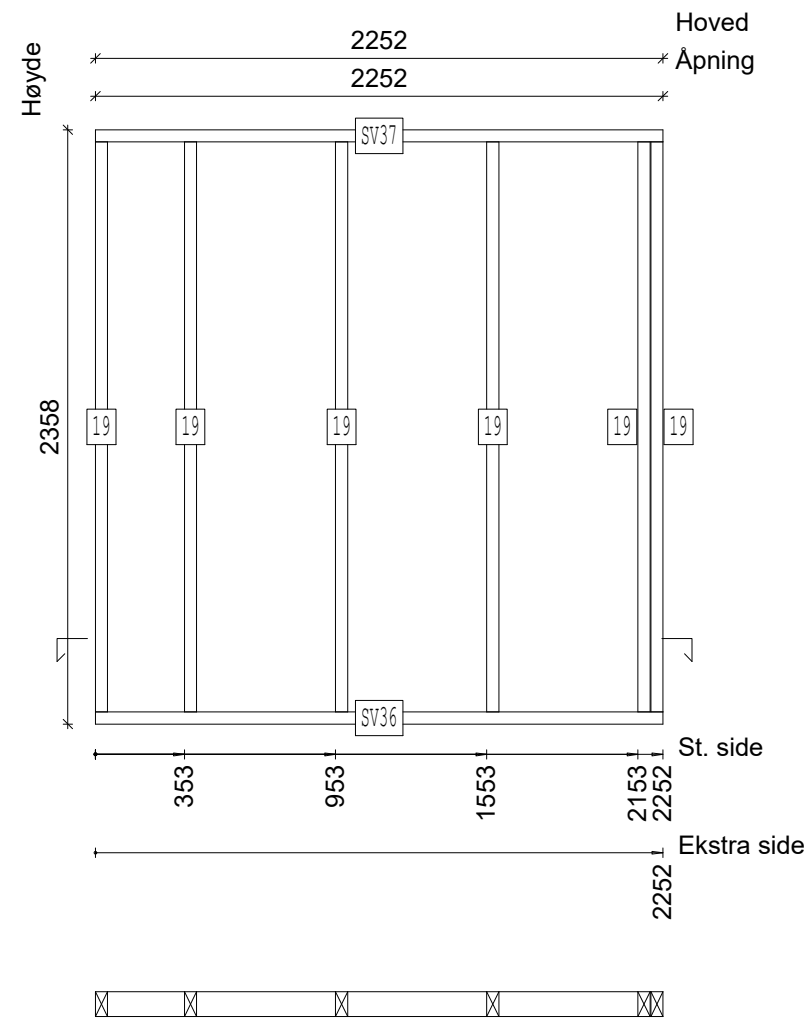

SVILLER				
LABEL	ANT	MATERIAL	TYPE	LENGDE
SV36	1	48x98 C16	BUNNSVILL	2252
SV37	1	48x98 C16	TOPPSVILL	2252

KAPPELISTE				
LABEL	ANT	MATERIAL	TYPE	LENGDE
19	6	48x98 C24	STENDER	2262

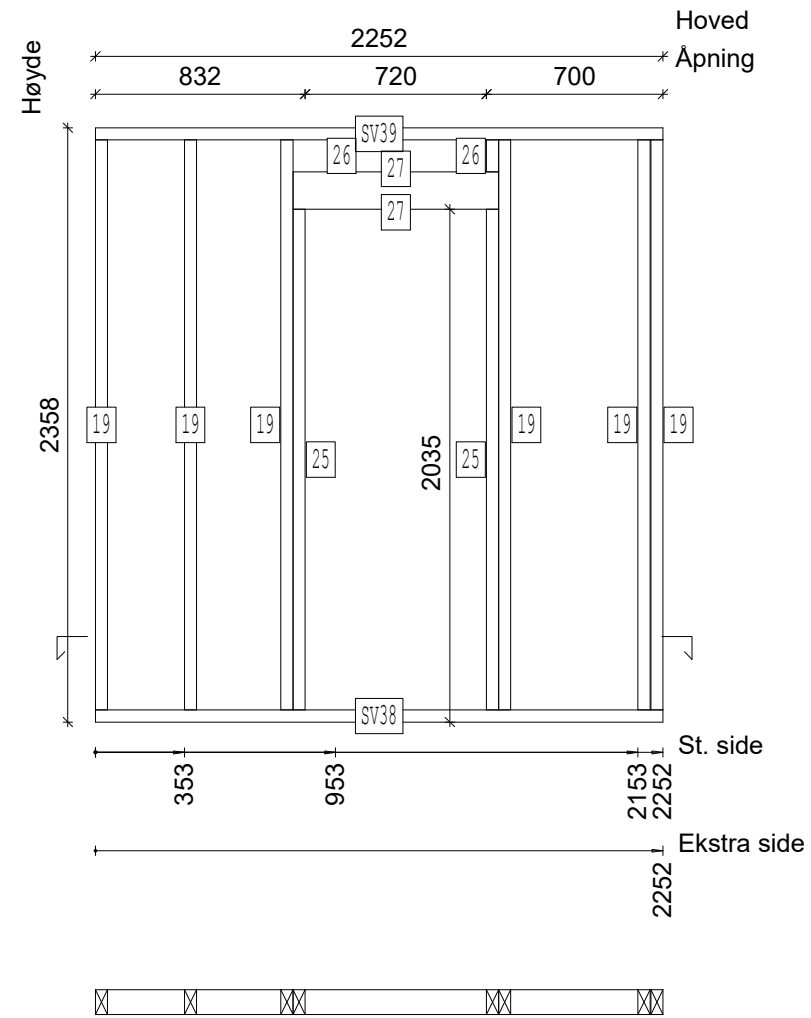

SVILLER				
LABEL	ANT	MATERIAL	TYPE	LENGDE
SV38	1	48x98 C16	BUNNSVILL	2252
SV39	1	48x98 C16	TOPPSVILL	2252

KAPPELISTE				
LABEL	ANT	MATERIAL	TYPE	LENGDE
19	6	48x98 C24	STENDER	2262
25	2	48x98 C24	KRYKKE	1987
26	2	48x98 C24	STENDER	127
27	2	48x148 C24	LOSHOLT	816

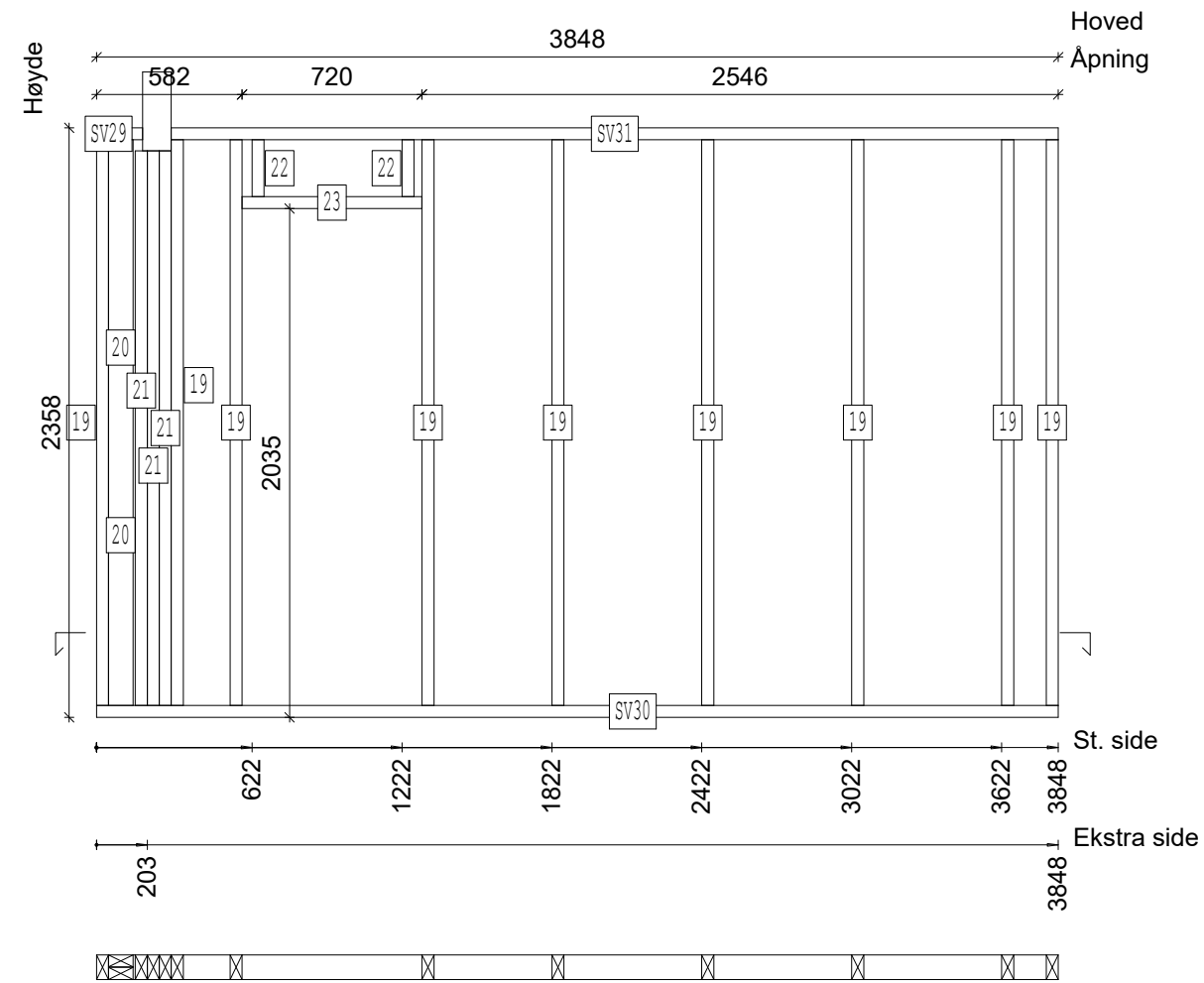

SVILLER				
LABEL	ANT	MATERIAL	TYPE	LENGDE
SV29	1	48x98 C16	TOPPSVILL	184
SV30	1	48x98 C16	BUNNSVILL	3848
SV31	1	48x98 C16	TOPPSVILL	3549

KAPPELISTE				
LABEL	ANT	MATERIAL	TYPE	LENGDE
19	9	48x98 C24	STENDER	2262
20	2	48x98 C24	STENDER	2262
21	3	48x98 C24	STENDER	2218
22	2	48x98 C24	STENDER	227
23	1	48x98 C24	LOSHOLT	720

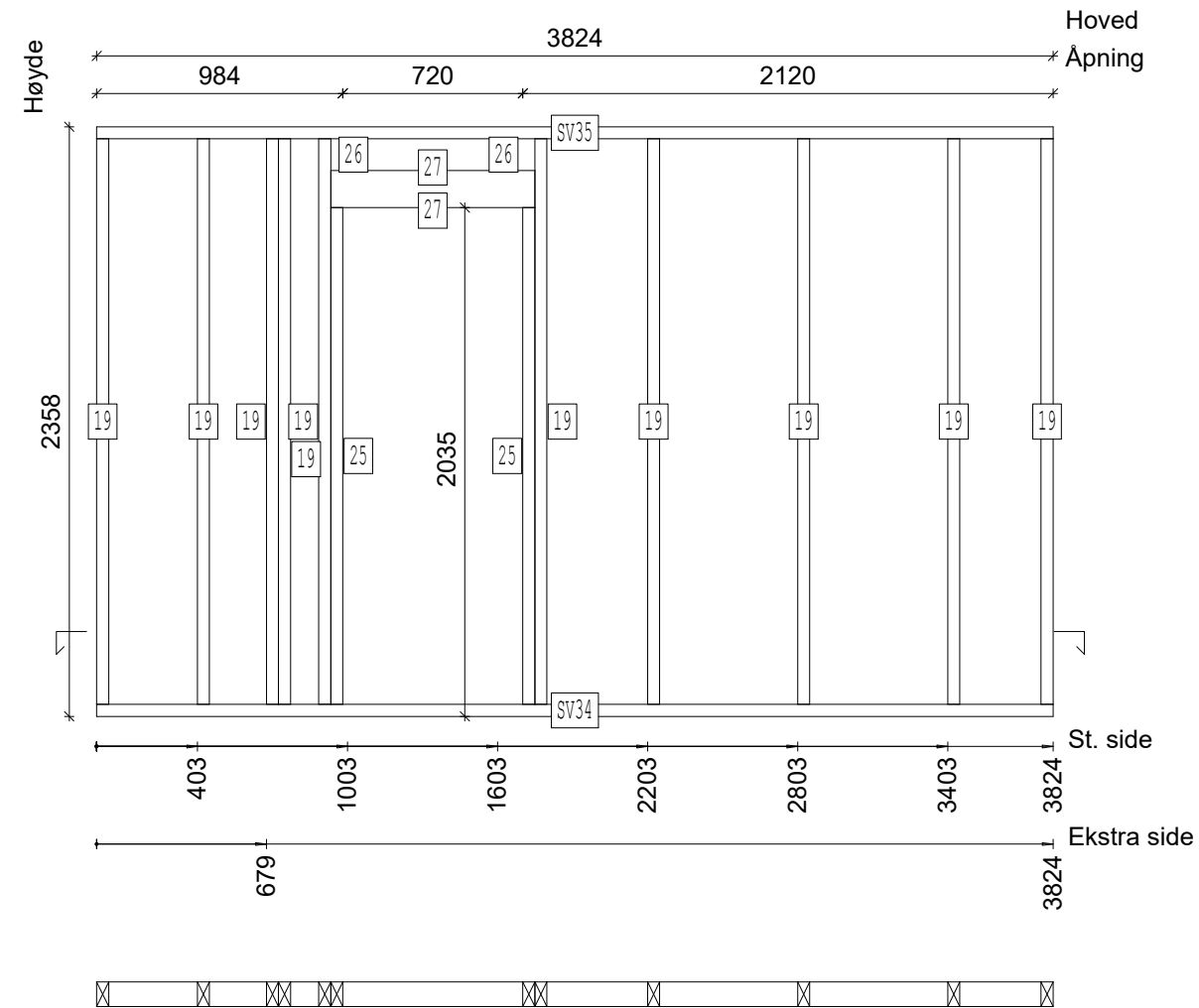

SVILLER				
LABEL	ANT	MATERIAL	TYPE	LENGDE
SV34	1	48x98 C16	BUNNSVILL	3824
SV35	1	48x98 C16	TOPPSVILL	3824

KAPPELISTE				
LABEL	ANT	MATERIAL	TYPE	LENGDE
19	10	48x98 C24	STENDER	2262
25	2	48x98 C24	KRYKKE	1987
26	2	48x98 C24	STENDER	127
27	2	48x148 C24	LOSHOLT	816

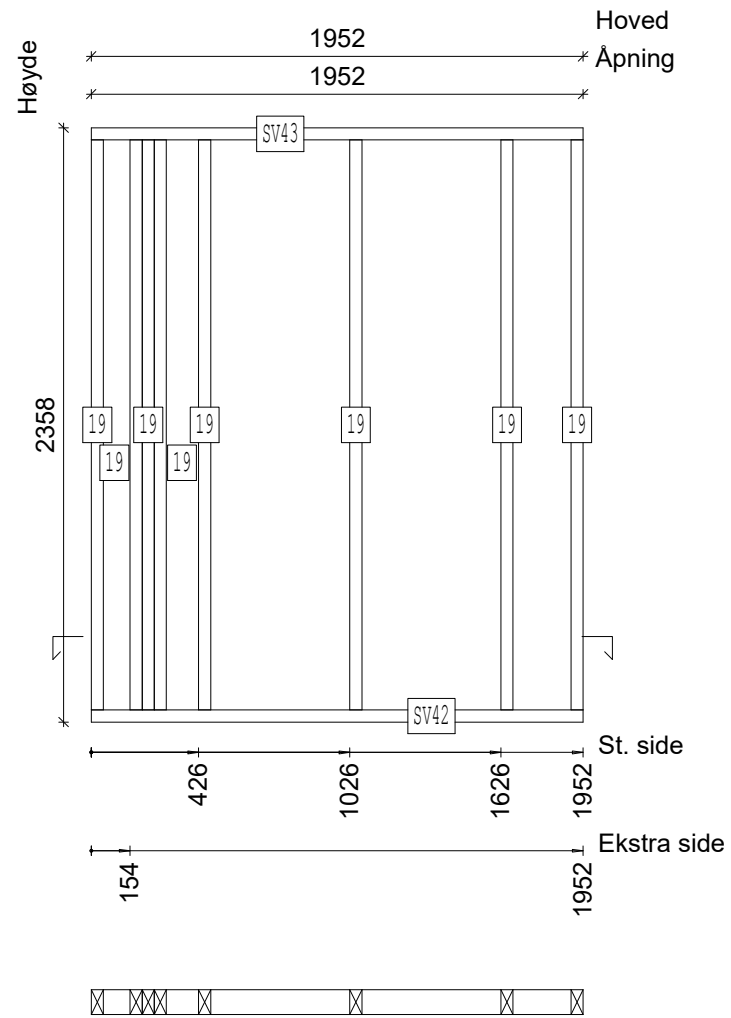

SVILLER				
LABEL	ANT	MATERIAL	TYPE	LENGDE
SV42	1	48x98 C16	BUNNSVILL	1952
SV43	1	48x98 C16	TOPPSVILL	1952

KAPPELISTE				
LABEL	ANT	MATERIAL	TYPE	LENGDE
19	8	48x98 C24	STENDER	2262

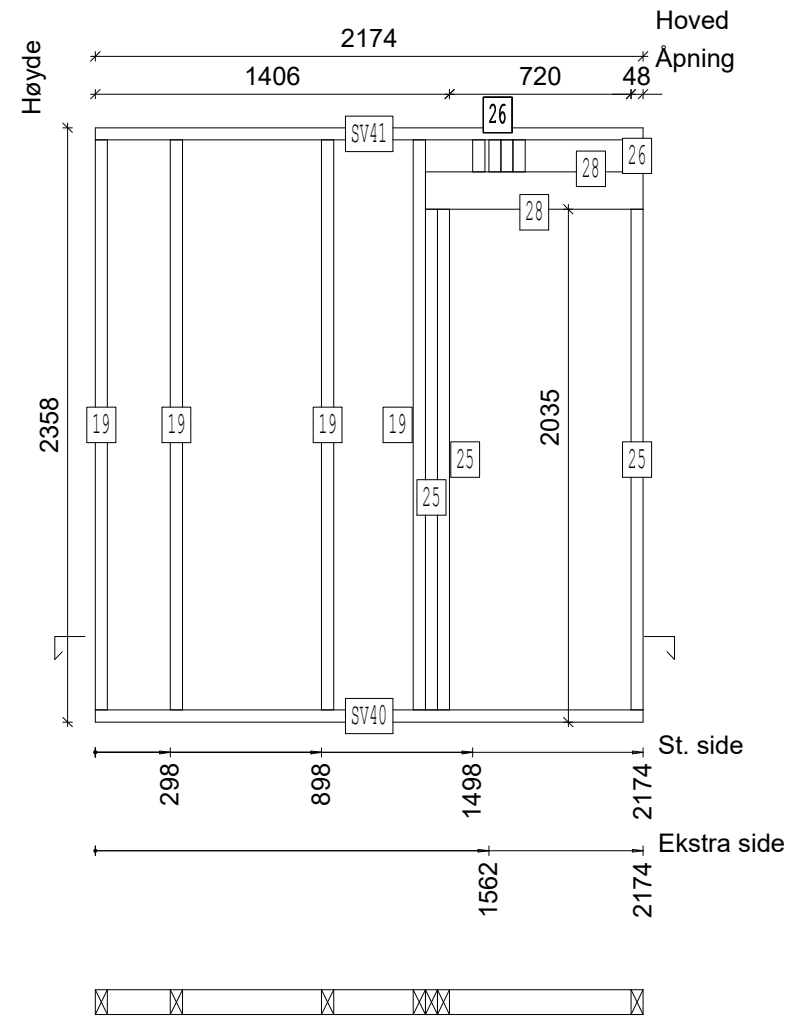

SVILLER				
LABEL	ANT	MATERIAL	TYPE	LENGDE
SV40	1	48x98 C16	BUNNSVILL	2174
SV41	1	48x98 C16	TOPPSVILL	2174

KAPPELISTE				
LABEL	ANT	MATERIAL	TYPE	LENGDE
19	4	48x98 C24	STENDER	2262
25	3	48x98 C24	KRYKKE	1987
26	5	48x98 C24	STENDER	127
28	2	48x148 C24	LOSHOLT	864

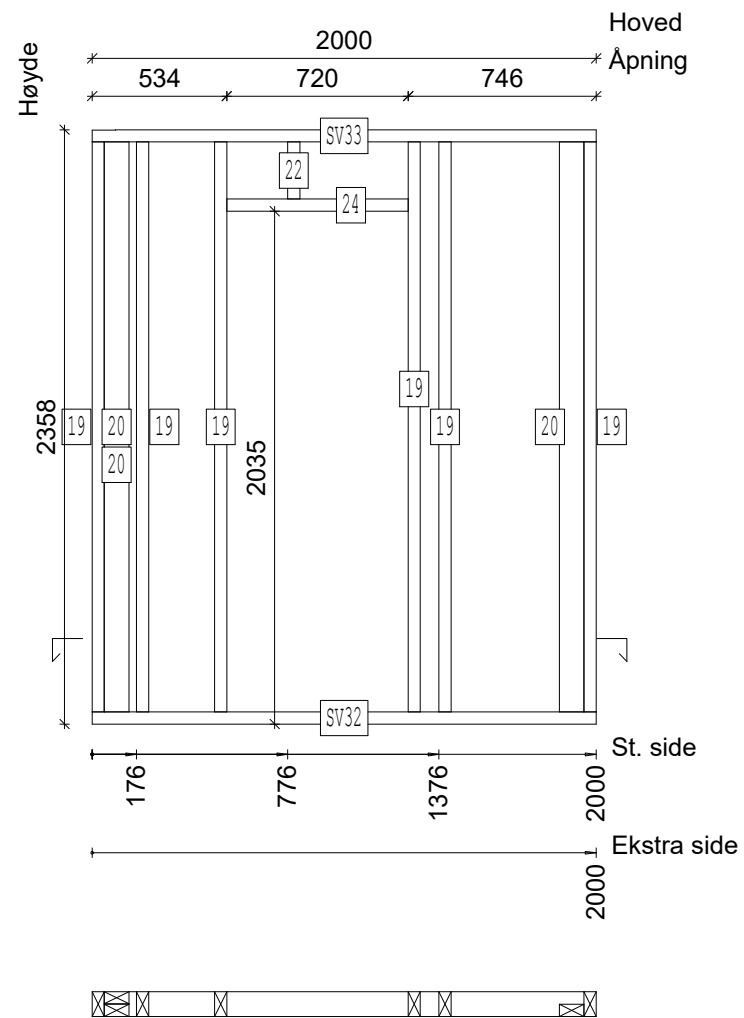

SVILLER				
LABEL	ANT	MATERIAL	TYPE	LENGDE
SV32	1	48x98 C16	BUNNSVILL	2000
SV33	1	48x98 C16	TOPPSVILL	2000

KAPPELISTE				
LABEL	ANT	MATERIAL	TYPE	LENGDE
19	6	48x98 C24	STENDER	2262
20	3	48x98 C24	STENDER	2262
22	1	48x98 C24	STENDER	227
24	1	48x98 C24	LOSHOLT	720

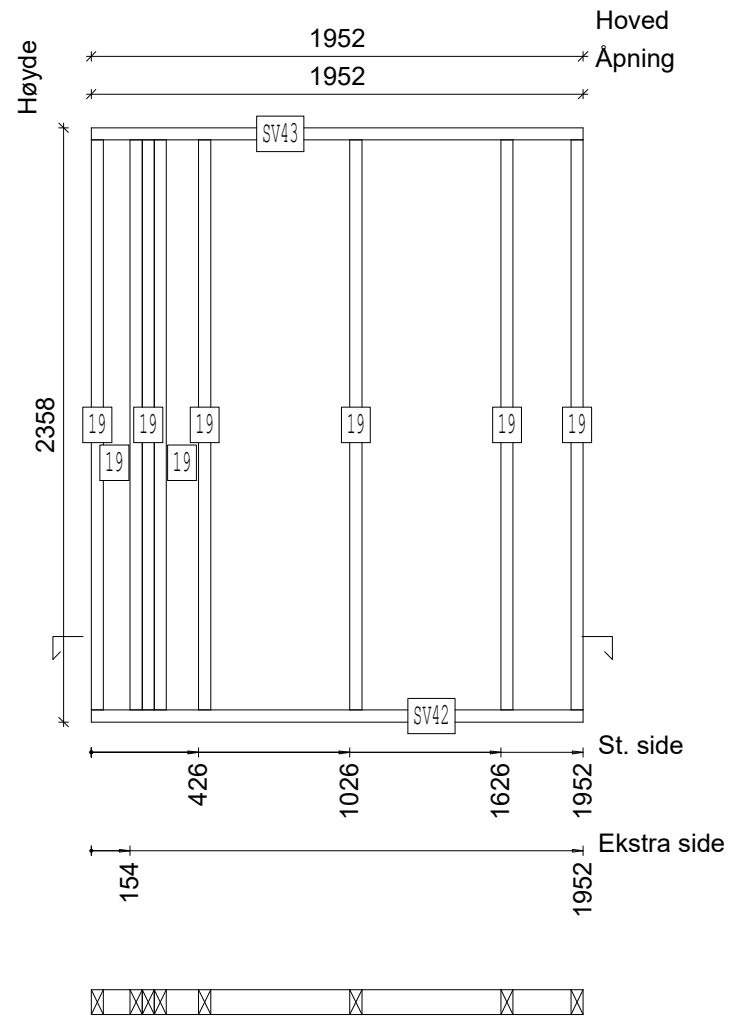

SVILLER				
LABEL	ANT	MATERIAL	TYPE	LENGDE
SV42	1	48x98 C16	BUNNSVILL	1952
SV43	1	48x98 C16	TOPPSVILL	1952

KAPPELISTE				
LABEL	ANT	MATERIAL	TYPE	LENGDE
19	8	48x98 C24	STENDER	2262

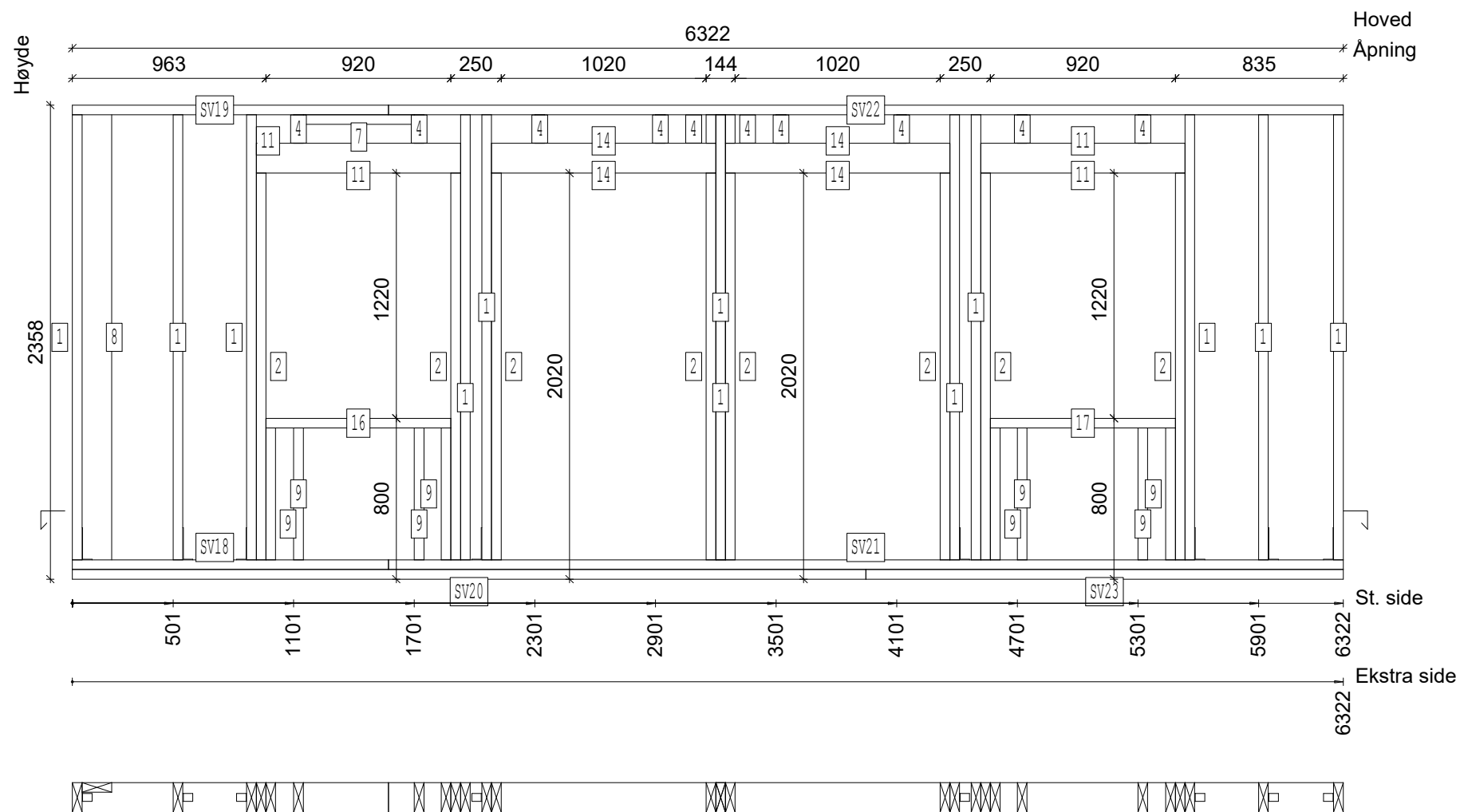

SVILLER				
LABEL	ANT	MATERIAL	TYPE	LENGDE
SV18	1	48x148 C16	BUNNSVILL	1572
SV19	1	48x148 C16	TOPPSVILL	1572
SV20	1	48x148 C16	BUNNSVILL	3947
SV21	1	48x148 C16	BUNNSVILL	4750
SV22	1	48x148 C16	TOPPSVILL	4750
SV23	1	48x148 C16	BUNNSVILL	2375

KAPPELISTE				
LABEL	ANT	MATERIAL	TYPE	LENGDE
1	12	48x148 C24	STENDER	2214
2	8	48x148 C24	KRYKKE	1924
4	10	48x148 C24	STENDER	142
7	1	48x148 C24	LASK	552
8	1	48x148 C24	STENDER	2214
9	8	48x148 C24	STENDER	656
11	4	48x148 C24	LOSHOLT	1016
14	4	48x148 C24	LOSHOLT	1116
16	1	48x148 C24	LOSHOLT	920
17	1	48x148 C24	LOSHOLT	920

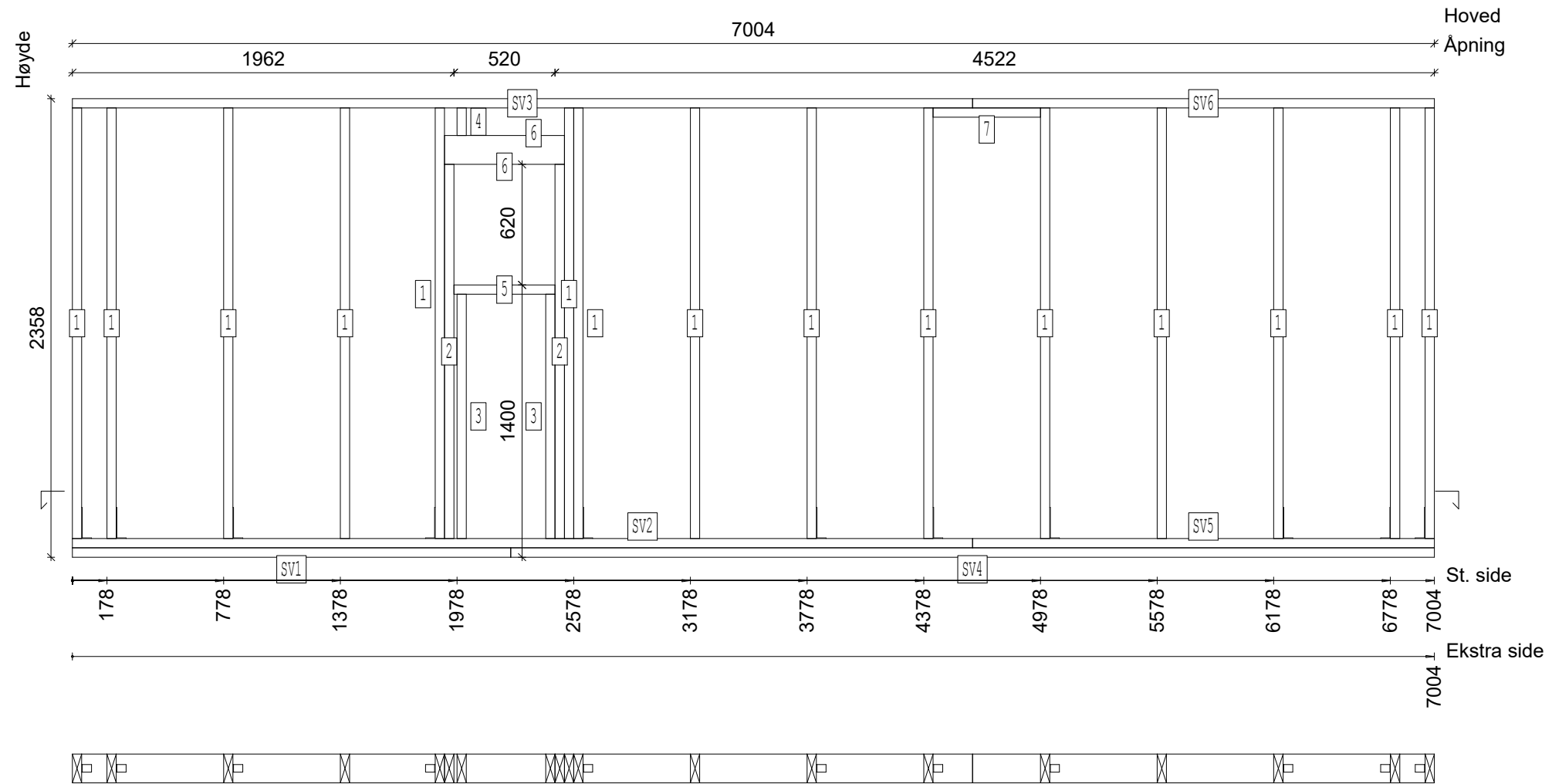

SVILLER				
LABEL	ANT	MATERIAL	TYPE	LENGDE
SV1	1	48x148 C16	BUNNSVILL	2254
SV2	1	48x148 C16	BUNNSVILL	4629
SV3	1	48x148 C16	TOPPSVILL	4629
SV4	1	48x148 C16	BUNNSVILL	4750
SV5	1	48x148 C16	BUNNSVILL	2375
SV6	1	48x148 C16	TOPPSVILL	2375

KAPPELISTE				
LABEL	ANT	MATERIAL	TYPE	LENGDE
1	15	48x148 C24	STENDER	2214
2	2	48x148 C24	KRYKKE	1924
3	2	48x148 C24	STENDER	1256
4	1	48x148 C24	STENDER	142
5	1	48x148 C24	LOSHOLT	520
6	2	48x148 C24	LOSHOLT	616
7	1	48x148 C24	LASK	552

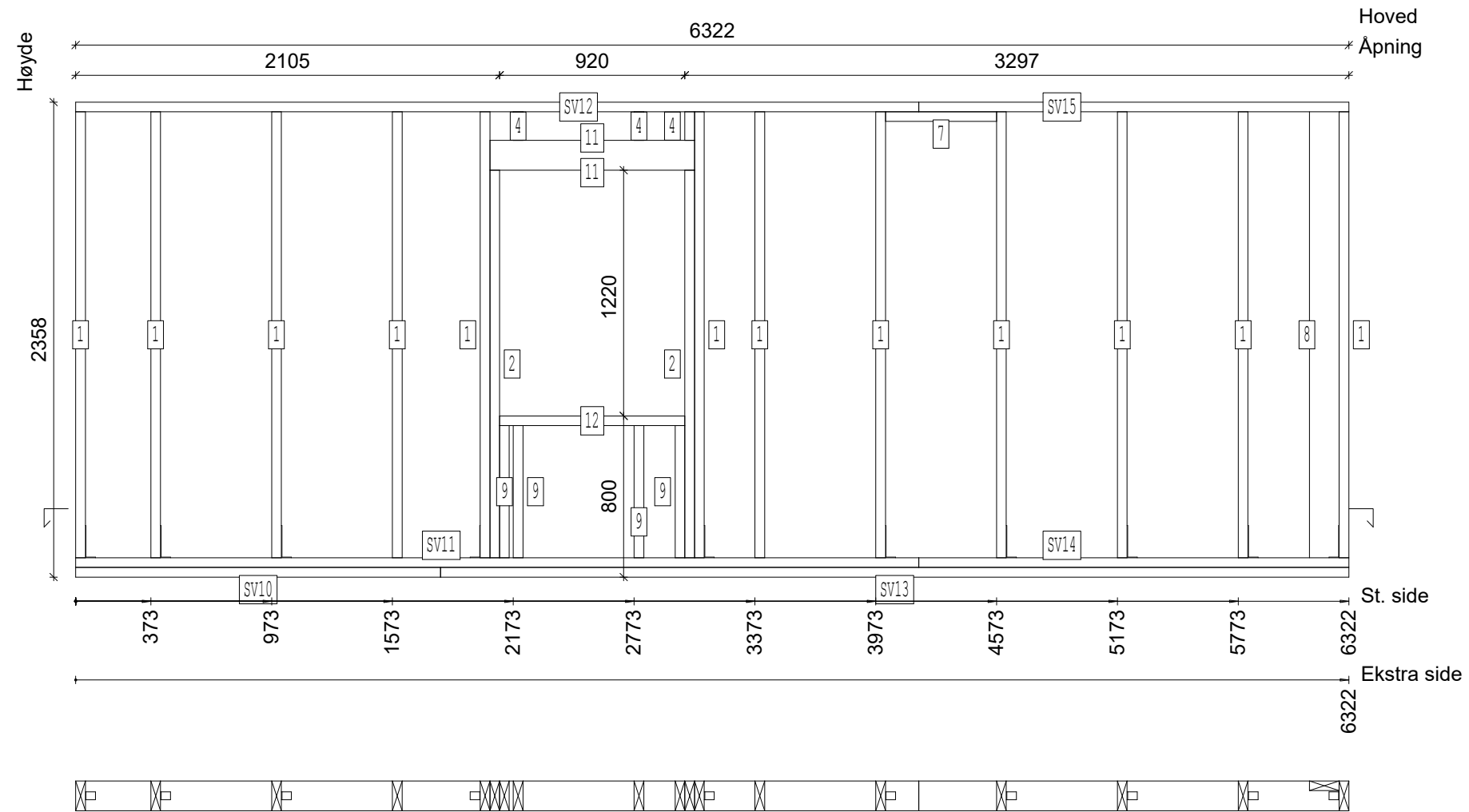

SVILLER				
LABEL	ANT	MATERIAL	TYPE	LENGDE
SV10	1	48x148 C16	BUNNSVILL	1812
SV11	1	48x148 C16	BUNNSVILL	4187
SV12	1	48x148 C16	TOPPSVILL	4187
SV13	1	48x148 C16	BUNNSVILL	4510
SV14	1	48x148 C16	BUNNSVILL	2135
SV15	1	48x148 C16	TOPPSVILL	2135

KAPPELISTE				
LABEL	ANT	MATERIAL	TYPE	LENGDE
1	12	48x148 C24	STENDER	2214
2	2	48x148 C24	KRYKKE	1924
4	3	48x148 C24	STENDER	142
7	1	48x148 C24	LASK	552
8	1	48x148 C24	STENDER	2214
9	4	48x148 C24	STENDER	656
11	2	48x148 C24	LOSHOLT	1016
12	1	48x148 C24	LOSHOLT	920

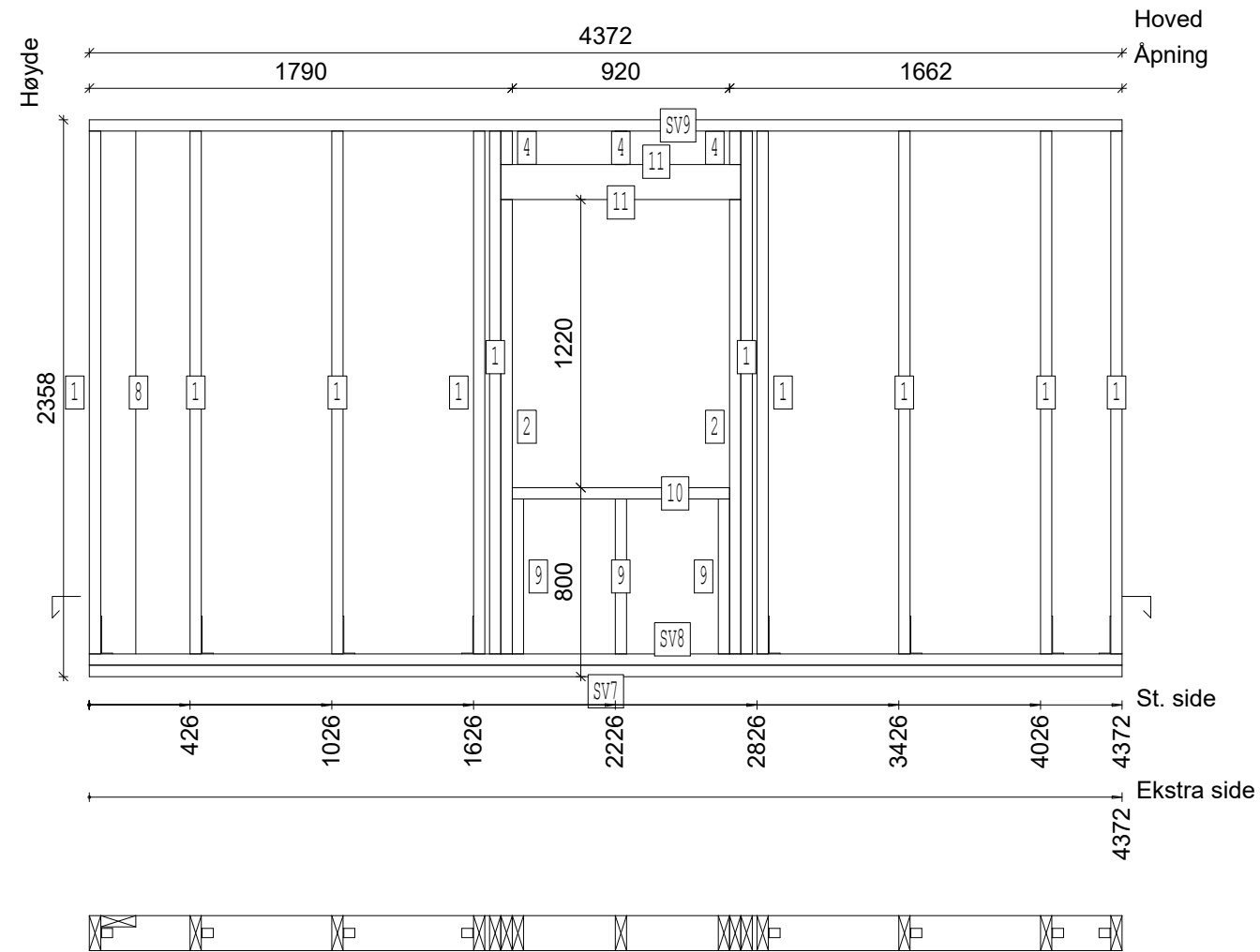

SVILLER				
LABEL	ANT	MATERIAL	TYPE	LENGDE
SV7	1	48x148 C16	BUNNSVILL	4372
SV8	1	48x148 C16	BUNNSVILL	4372
SV9	1	48x148 C16	TOPPSVILL	4372

KAPPELISTE				
LABEL	ANT	MATERIAL	TYPE	LENGDE
1	10	48x148 C24	STENDER	2214
2	2	48x148 C24	KRYKKE	1924
4	3	48x148 C24	STENDER	142
8	1	48x148 C24	STENDER	2214
9	3	48x148 C24	STENDER	656
10	1	48x148 C24	LOSHOLT	920
11	2	48x148 C24	LOSHOLT	1016

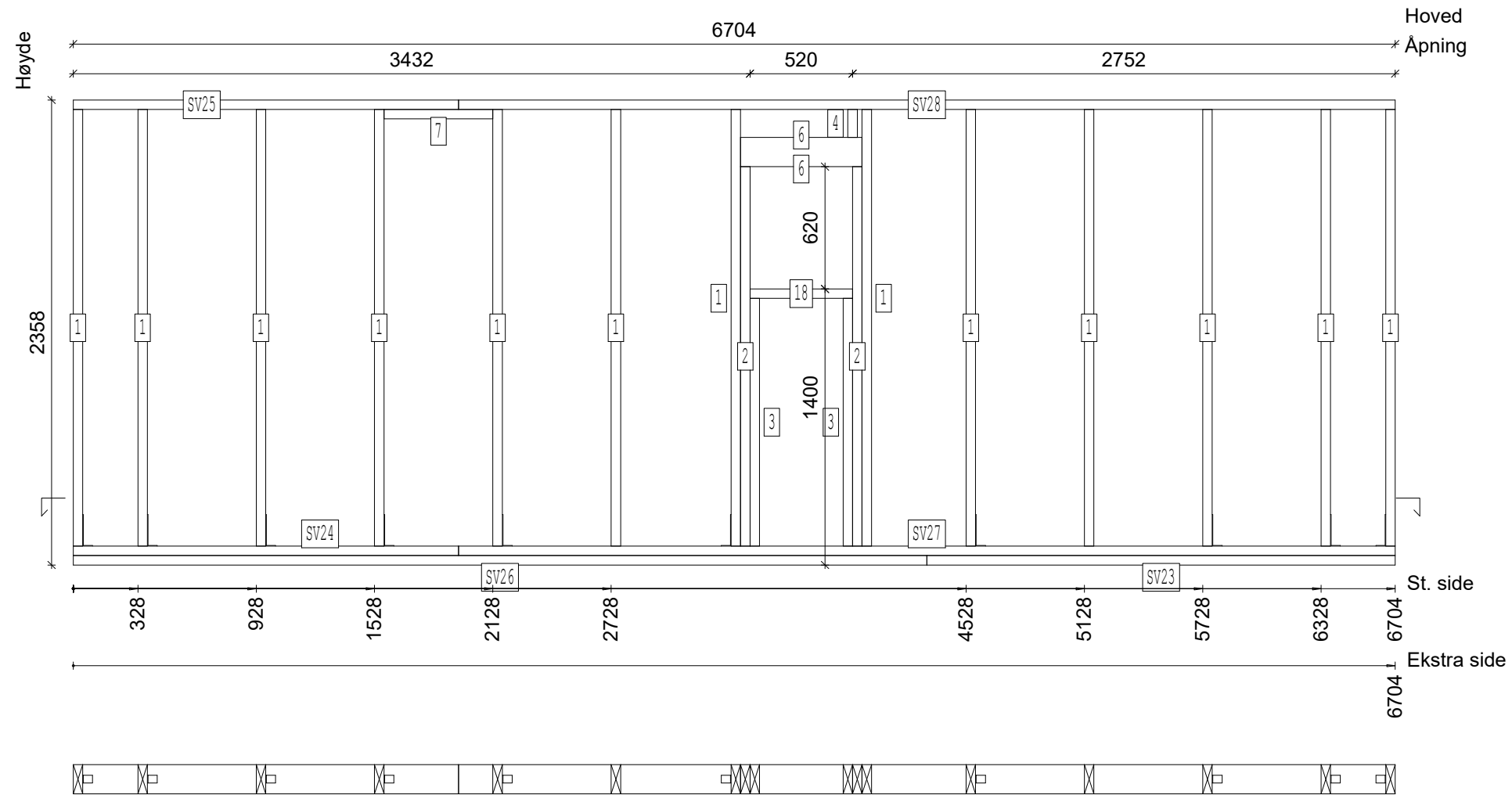

SVILLER				
LABEL	ANT	MATERIAL	TYPE	LENGDE
SV23	1	48x148 C16	BUNNSVILL	2375
SV24	1	48x148 C16	BUNNSVILL	1954
SV25	1	48x148 C16	TOPPSVILL	1954
SV26	1	48x148 C16	BUNNSVILL	4329
SV27	1	48x148 C16	BUNNSVILL	4750
SV28	1	48x148 C16	TOPPSVILL	4750

KAPPELISTE				
LABEL	ANT	MATERIAL	TYPE	LENGDE
1	13	48x148 C24	STENDER	2214
2	2	48x148 C24	KRYKKE	1924
3	2	48x148 C24	STENDER	1256
4	1	48x148 C24	STENDER	142
6	2	48x148 C24	LOSHOLT	616
7	1	48x148 C24	LASK	552
18	1	48x148 C24	LOSHOLT	520

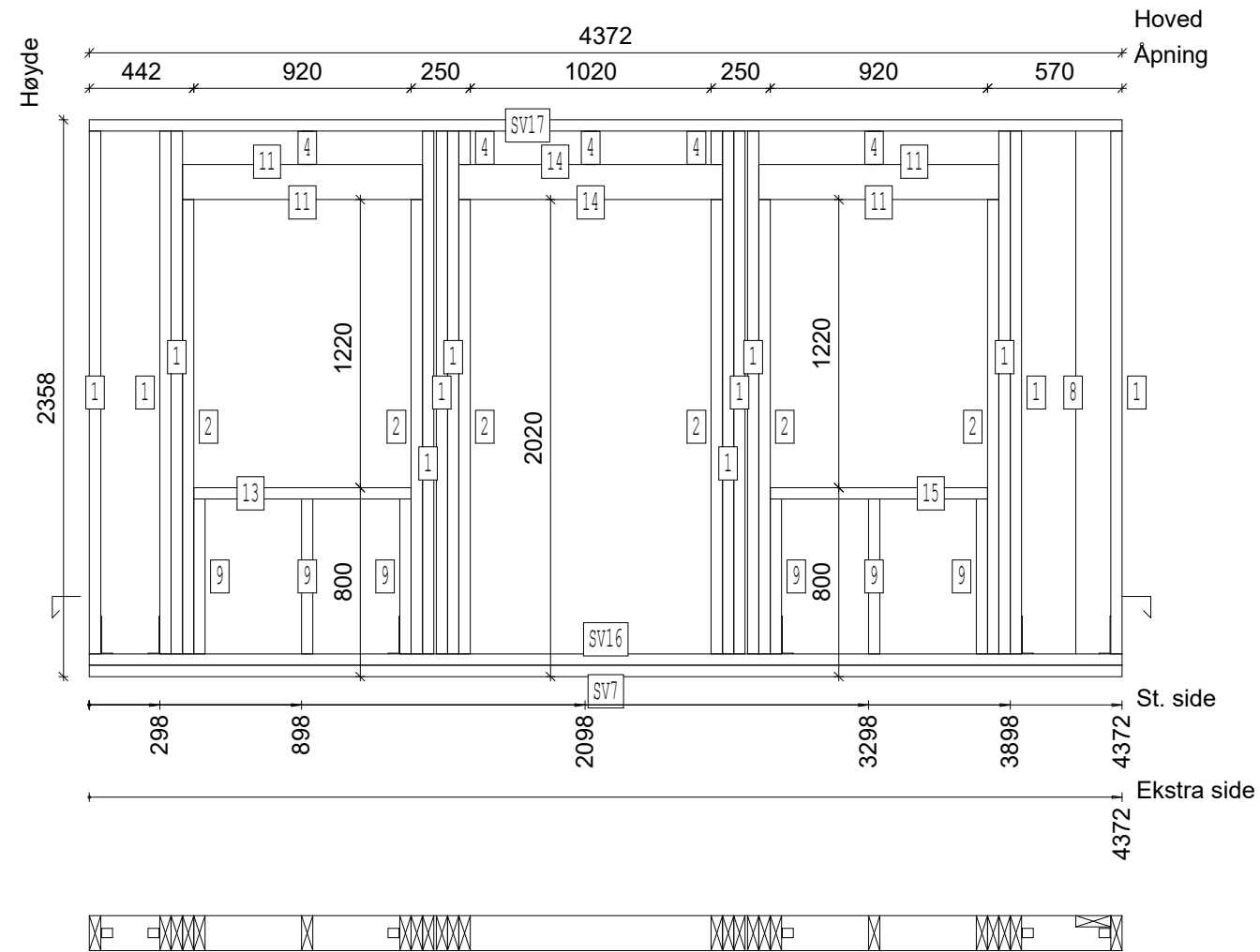

SVILLER				
LABEL	ANT	MATERIAL	TYPE	LENGDE
SV7	1	48x148 C16	BUNNSVILL	4372
SV16	1	48x148 C16	BUNNSVILL	4372
SV17	1	48x148 C16	TOPPSVILL	4372

KAPPELISTE				
LABEL	ANT	MATERIAL	TYPE	LENGDE
1	12	48x148 C24	STENDER	2214
2	6	48x148 C24	KRYKKE	1924
4	5	48x148 C24	STENDER	142
8	1	48x148 C24	STENDER	2214
9	6	48x148 C24	STENDER	656
11	4	48x148 C24	LOSHOLT	1016
13	1	48x148 C24	LOSHOLT	920
14	2	48x148 C24	LOSHOLT	1116
15	1	48x148 C24	LOSHOLT	920

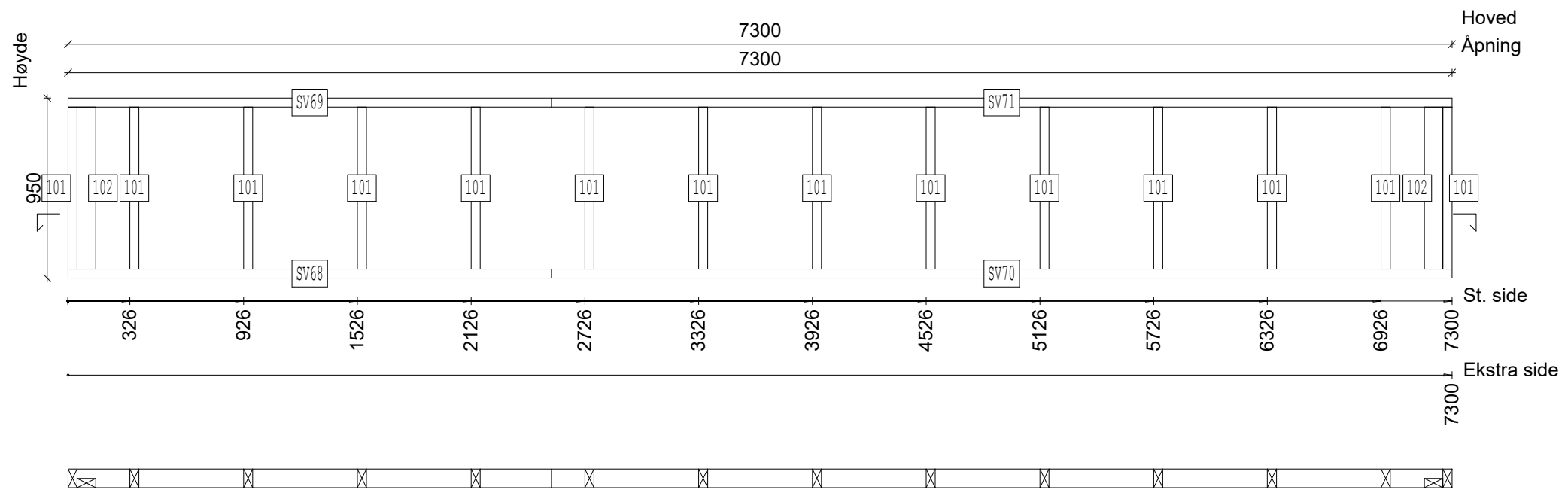

SVILLER				
LABEL	ANT	MATERIAL	TYPE	LENGDE
SV68	1	48x98 C16	BUNNSVILL	2550
SV69	1	48x98 C16	TOPPSVILL	2550
SV70	1	48x98 C16	BUNNSVILL	4750
SV71	1	48x98 C16	TOPPSVILL	4750

KAPPELISTE				
LABEL	ANT	MATERIAL	TYPE	LENGDE
101	14	48x98 C24	STENDER	854
102	2	48x98 C24	STENDER	854

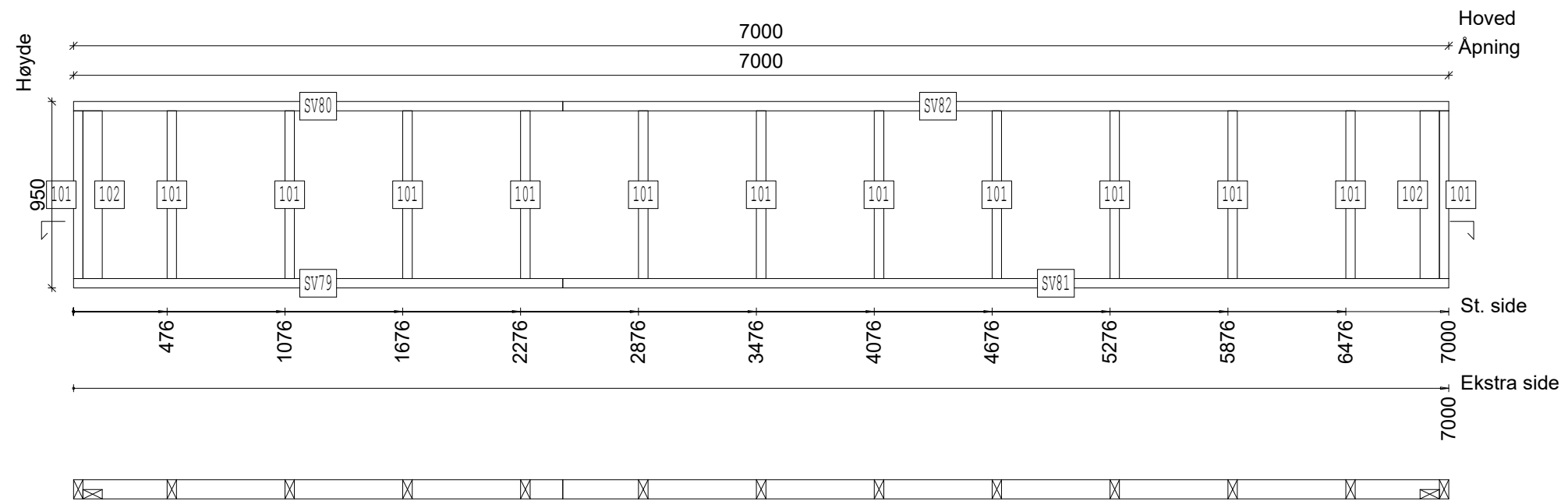

SVILLER				
LABEL	ANT	MATERIAL	TYPE	LENGDE
SV79	1	48x98 C16	BUNNSVILL	2490
SV80	1	48x98 C16	TOPPSVILL	2490
SV81	1	48x98 C16	BUNNSVILL	4510
SV82	1	48x98 C16	TOPPSVILL	4510

KAPPELISTE				
LABEL	ANT	MATERIAL	TYPE	LENGDE
101	13	48x98 C24	STENDER	854
102	2	48x98 C24	STENDER	854

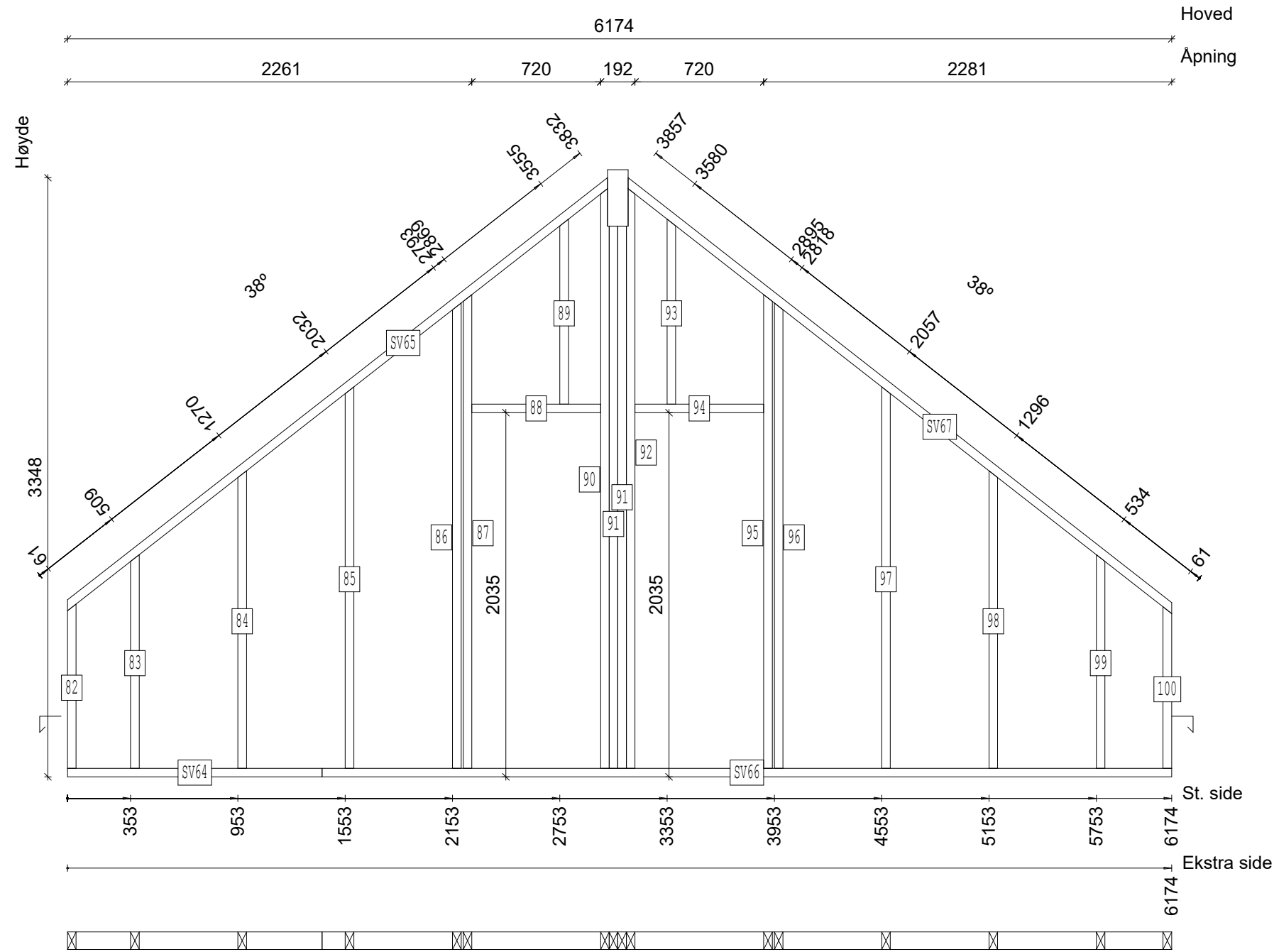

KAPPELISTE				
LABEL	ANT	MATERIAL	TYPE	LENGDE
82	1	48x98 C24	STENDER	918
83	1	48x98 C24	STENDER	1193
84	1	48x98 C24	STENDER	1662
85	1	48x98 C24	STENDER	2131
86	1	48x98 C24	STENDER	2600
87	1	48x98 C24	STENDER	2647
88	1	48x98 C24	LOSHOLT	720
89	1	48x98 C24	STENDER	1034
90	1	48x98 C24	STENDER	3239
91	2	48x98 C24	STENDER	3030
92	1	48x98 C24	STENDER	3239
93	1	48x98 C24	STENDER	1034
94	1	48x98 C24	LOSHOLT	720
95	1	48x98 C24	STENDER	2647
96	1	48x98 C24	STENDER	2600
97	1	48x98 C24	STENDER	2131
98	1	48x98 C24	STENDER	1662
99	1	48x98 C24	STENDER	1193
100	1	48x98 C24	STENDER	902

SVILLER				
LABEL	ANT	MATERIAL	TYPE	LENGDE
SV64	1	48x98 C16	BUNNSVILL	1424
SV65	1	48x98 C16	TOPPSVILL	3869
SV66	1	48x98 C16	BUNNSVILL	4750
SV67	1	48x98 C16	TOPPSVILL	3895

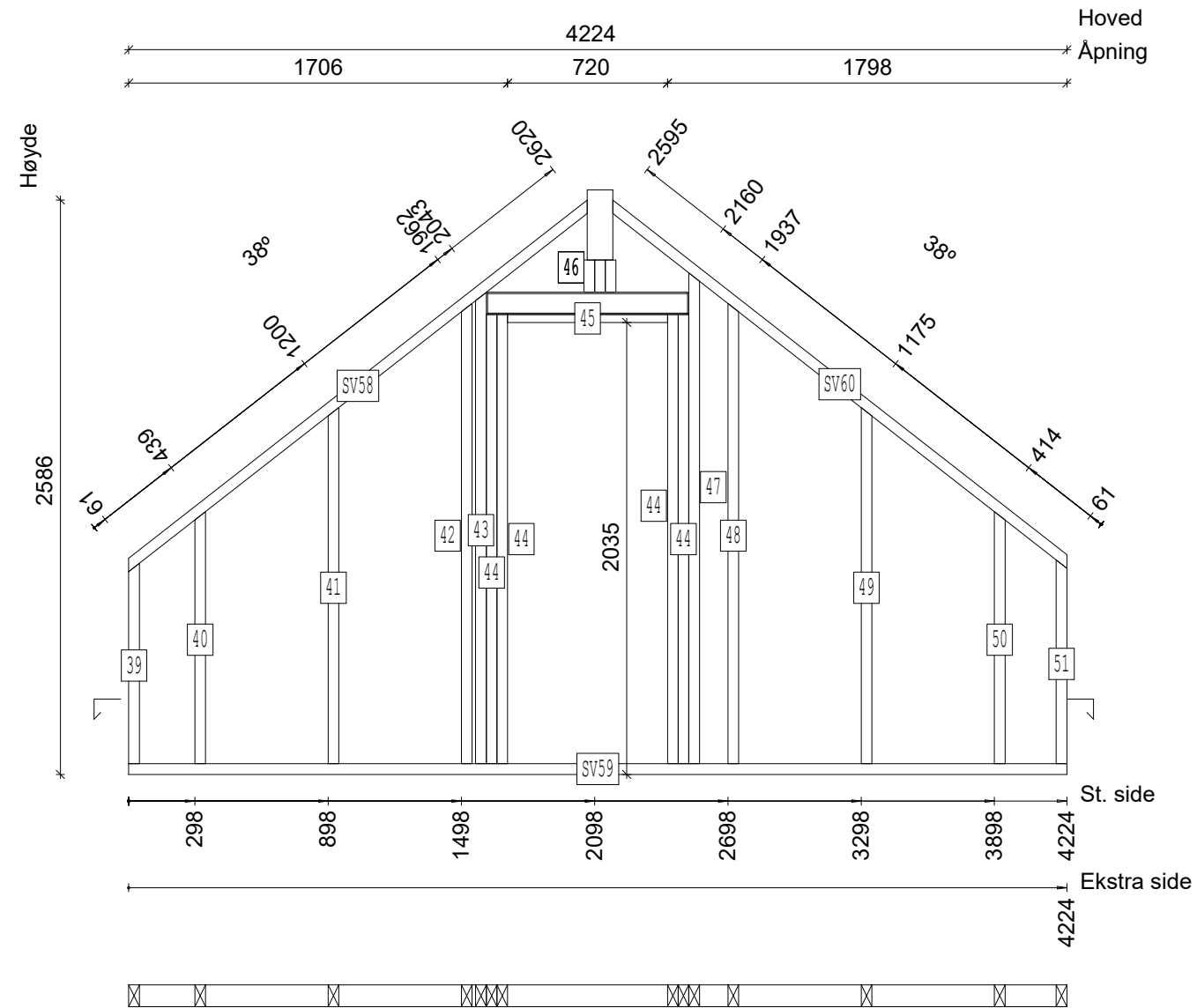

KAPPELISTE				
LABEL	ANT	MATERIAL	TYPE	LENGDE
39	1	48x98 C24	STENDER	902
40	1	48x98 C24	STENDER	1135
41	1	48x98 C24	STENDER	1604
42	1	48x98 C24	STENDER	2072
43	1	48x98 C24	STENDER	2122
44	4	48x98 C24	KRYKKE	2023
45	1	36x98 C24	LOSHOLT	720
46	3	48x98 C24	STENDER	146
47	1	48x98 C24	STENDER	2210
48	1	48x98 C24	STENDER	2072
49	1	48x98 C24	STENDER	1604
50	1	48x98 C24	STENDER	1135
51	1	48x98 C24	STENDER	918

SVILLER				
LABEL	ANT	MATERIAL	TYPE	LENGDE
SV58	1	48x98 C16	TOPPSVILL	2657
SV59	1	48x98 C16	BUNNSVILL	4224
SV60	1	48x98 C16	TOPPSVILL	2632

Elementareal: 25.4 m²	Elementnr: 2Y1	Prosjekt: VS10043
--	--------------------------	-----------------------------

07.09.2017

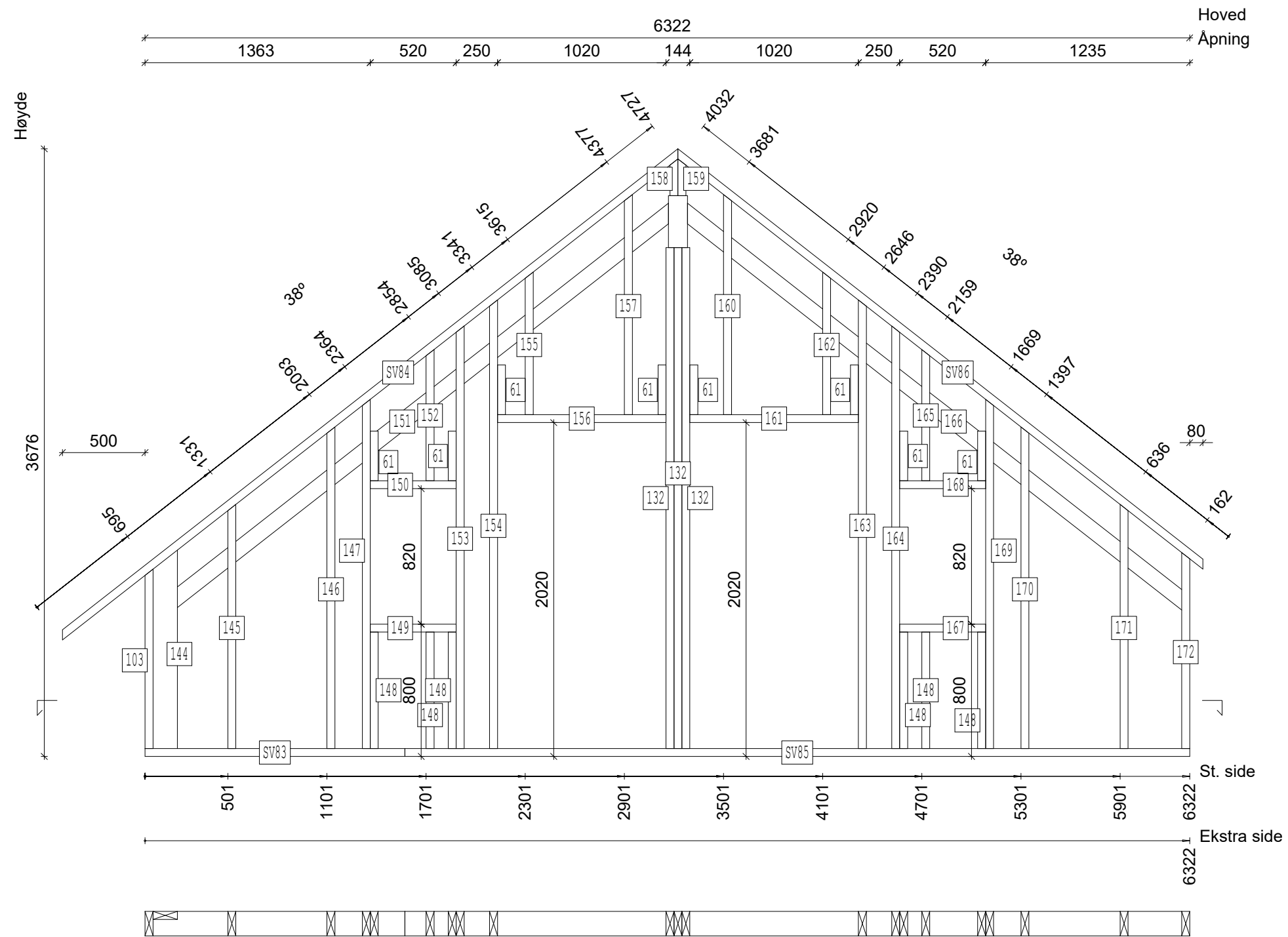

KAPPELISTE				
LABEL	ANT	MATERIAL	TYPE	LENGDE
61	8	48x148 C24	STENDER	300
103	1	48x148 C24	STENDER	1085
132	3	48x148 C24	STENDER	3030
144	1	48x148 C24	STENDER	1201
145	1	48x148 C24	STENDER	1476
146	1	48x148 C24	STENDER	1945
147	1	48x148 C24	STENDER	2112
148	6	48x148 C24	STENDER	704
149	1	48x148 C24	LOSHOLT	520
150	1	48x148 C24	LOSHOLT	520
151	1	23x98 C24	SPIKERSLAG	3847
152	1	48x148 C24	STENDER	794
153	1	48x148 C24	STENDER	2556
154	1	48x148 C24	STENDER	2714
155	1	48x148 C24	STENDER	863
156	1	48x148 C24	LOSHOLT	1020
157	1	48x148 C24	STENDER	1332
158	1	48x148 C24	STENDER	222
159	1	48x148 C24	STENDER	222
160	1	48x148 C24	STENDER	1332
161	1	48x148 C24	LOSHOLT	1020
162	1	48x148 C24	STENDER	863
163	1	48x148 C24	STENDER	2714
164	1	48x148 C24	STENDER	2556
165	1	48x148 C24	STENDER	794
166	1	23x98 C24	SPIKERSLAG	3934
167	1	48x148 C24	LOSHOLT	520
168	1	48x148 C24	LOSHOLT	520
169	1	48x148 C24	STENDER	2112
170	1	48x148 C24	STENDER	1945
171	1	48x148 C24	STENDER	1476
172	1	48x148 C24	STENDER	1185

SVILLER				
LABEL	ANT	MATERIAL	TYPE	LENGDE
SV83	1	48x148 C16	BUNNSVILL	1572
SV84	1	48x148 C16	TOPPSVILL	4765
SV85	1	48x148 C16	BUNNSVILL	4750
SV86	1	48x148 C16	TOPPSVILL	4069

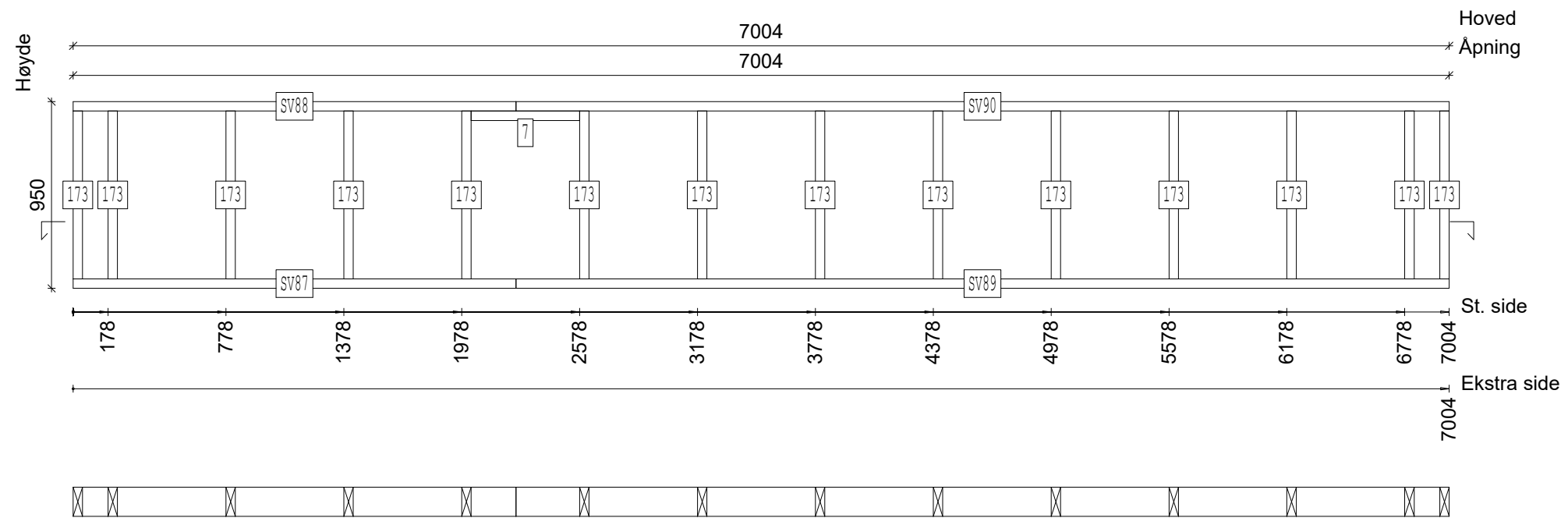

SVILLER				
LABEL	ANT	MATERIAL	TYPE	LENGDE
SV87	1	48x148 C16	BUNNSVILL	2254
SV88	1	48x148 C16	TOPPSVILL	2254
SV89	1	48x148 C16	BUNNSVILL	4750
SV90	1	48x148 C16	TOPPSVILL	4750

KAPPELISTE				
LABEL	ANT	MATERIAL	TYPE	LENGDE
7	1	48x148 C24	LASK	552
173	14	48x148 C24	STENDER	854

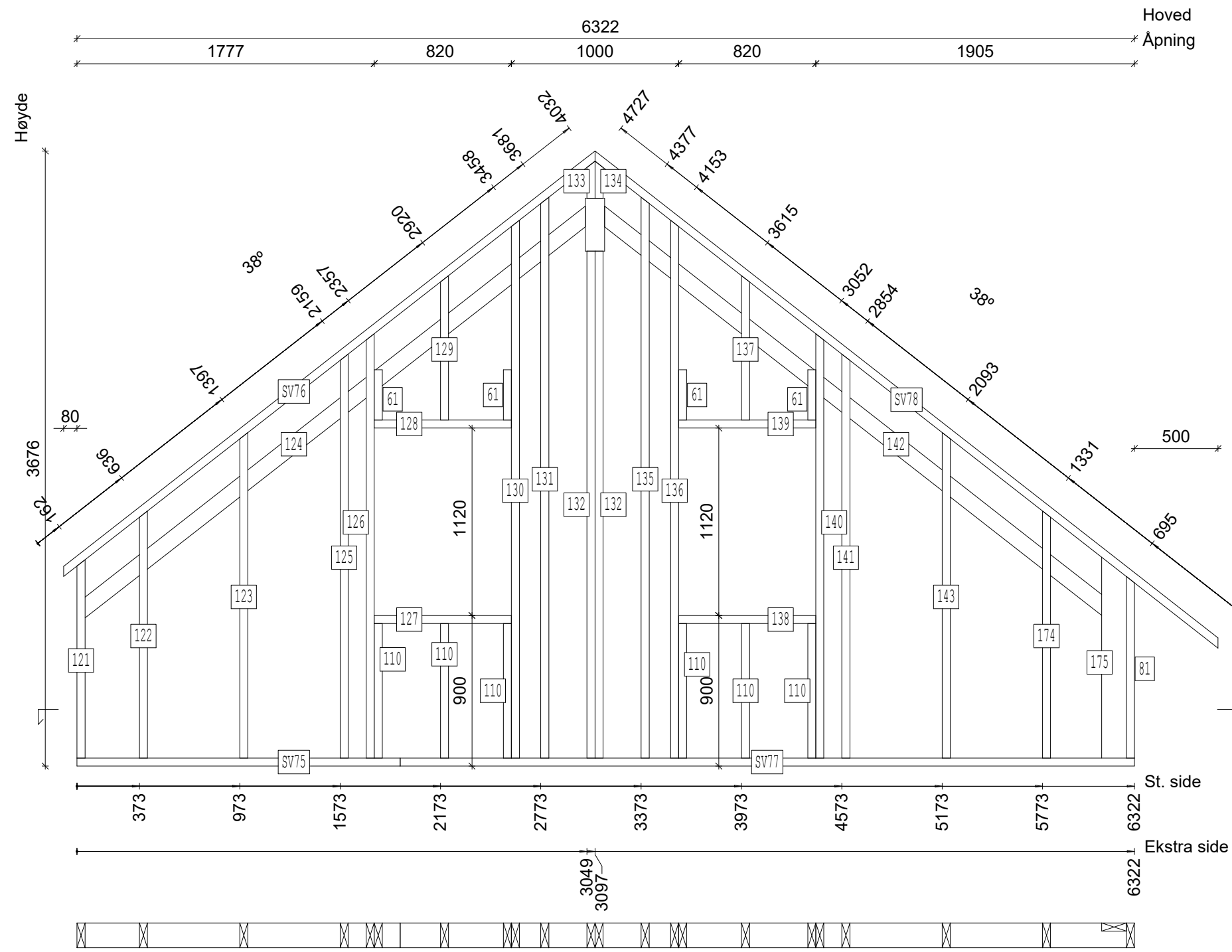

KAPPELISTE				
LABEL	ANT	MATERIAL	TYPE	LENGDE
61	4	48x148 C24	STENDER	300
81	1	48x148 C24	STENDER	1085
110	6	48x148 C24	STENDER	804
121	1	48x148 C24	STENDER	1185
122	1	48x148 C24	STENDER	1476
123	1	48x148 C24	STENDER	1945
124	1	23x98 C24	SPIKERSLAG	3934
125	1	48x148 C24	STENDER	2414
126	1	48x148 C24	STENDER	2536
127	1	48x148 C24	LOSHOLT	820
128	1	48x148 C24	LOSHOLT	820
129	1	48x148 C24	STENDER	863
130	1	48x148 C24	STENDER	3214
131	1	48x148 C24	STENDER	3352
132	2	48x148 C24	STENDER	3030
133	1	48x148 C24	STENDER	222
134	1	48x148 C24	STENDER	222
135	1	48x148 C24	STENDER	3352
136	1	48x148 C24	STENDER	3214
137	1	48x148 C24	STENDER	863
138	1	48x148 C24	LOSHOLT	820
139	1	48x148 C24	LOSHOLT	820
140	1	48x148 C24	STENDER	2536
141	1	48x148 C24	STENDER	2414
142	1	23x98 C24	SPIKERSLAG	3847
143	1	48x148 C24	STENDER	1945
174	1	48x148 C24	STENDER	1476
175	1	48x148 C24	STENDER	1201

SVILLER				
LABEL	ANT	MATERIAL	TYPE	LENGDE
SV75	1	48x148 C16	BUNNSVILL	1932
SV76	1	48x148 C16	TOPPSVILL	4069
SV77	1	48x148 C16	BUNNSVILL	4390
SV78	1	48x148 C16	TOPPSVILL	4765

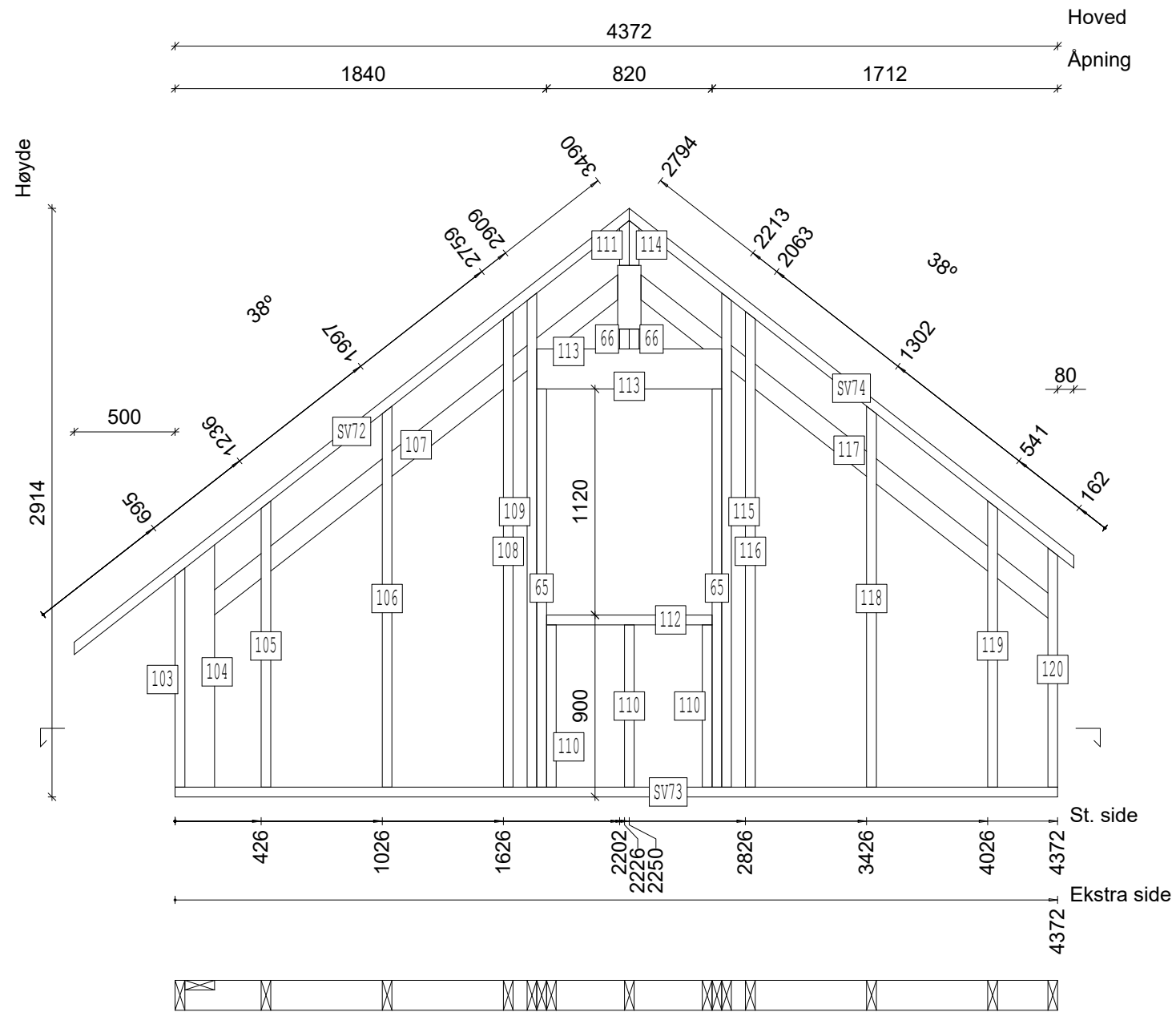

KAPPELISTE				
LABEL	ANT	MATERIAL	TYPE	LENGDE
65	2	48x148 C24	KRYKKE	1972
66	2	48x148 C24	STENDER	99
103	1	48x148 C24	STENDER	1085
104	1	48x148 C24	STENDER	1201
105	1	48x148 C24	STENDER	1418
106	1	48x148 C24	STENDER	1887
107	1	23x98 C24	SPIKERSLAG	2610
108	1	48x148 C24	STENDER	2355
109	1	48x148 C24	STENDER	2448
110	3	48x148 C24	STENDER	804
111	1	48x148 C24	STENDER	222
112	1	48x148 C24	LOSHOLT	820
113	2	48x198 C24	LOSHOLT	916
114	1	48x148 C24	STENDER	222
115	1	48x148 C24	STENDER	2448
116	1	48x148 C24	STENDER	2355
117	1	23x98 C24	SPIKERSLAG	2696
118	1	48x148 C24	STENDER	1887
119	1	48x148 C24	STENDER	1418
120	1	48x148 C24	STENDER	1185

SVILLER				
LABEL	ANT	MATERIAL	TYPE	LENGDE
SV72	1	48x148 C16	TOPPSVILL	3527
SV73	1	48x148 C16	BUNNSVILL	4372
SV74	1	48x148 C16	TOPPSVILL	2832

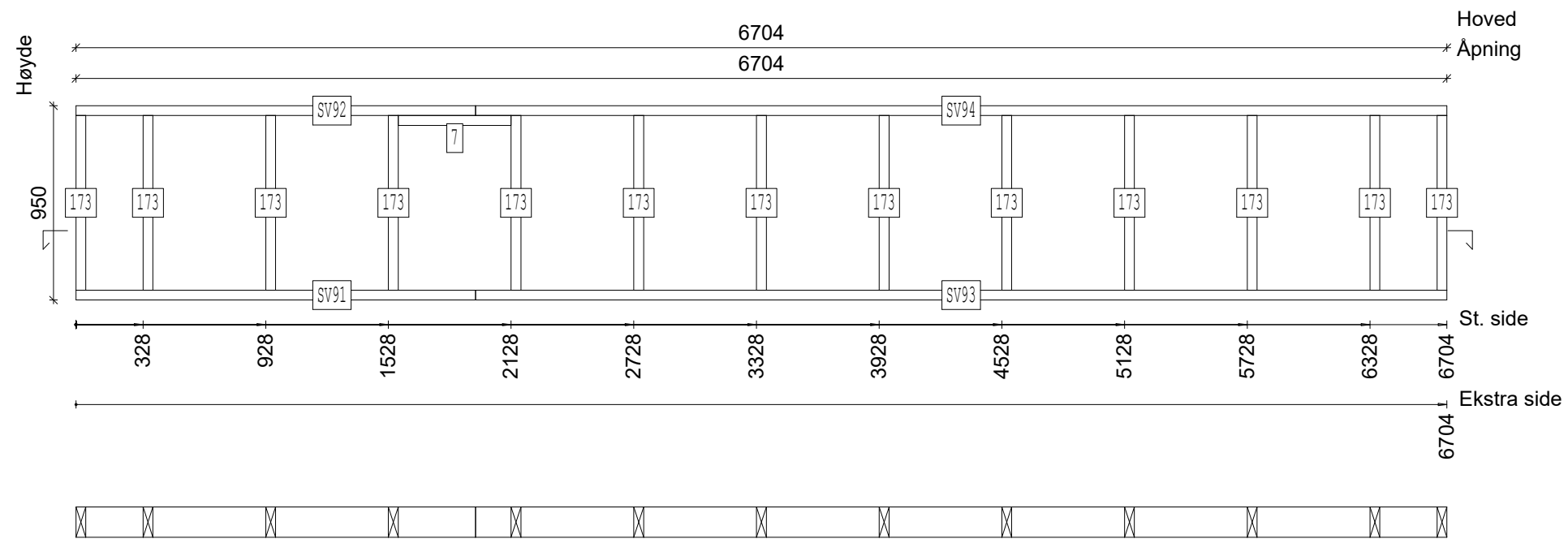

SVILLER				
LABEL	ANT	MATERIAL	TYPE	LENGDE
SV91	1	48x148 C16	BUNNSVILL	1954
SV92	1	48x148 C16	TOPPSVILL	1954
SV93	1	48x148 C16	BUNNSVILL	4750
SV94	1	48x148 C16	TOPPSVILL	4750

KAPPELISTE				
LABEL	ANT	MATERIAL	TYPE	LENGDE
7	1	48x148 C24	LASK	552
173	13	48x148 C24	STENDER	854

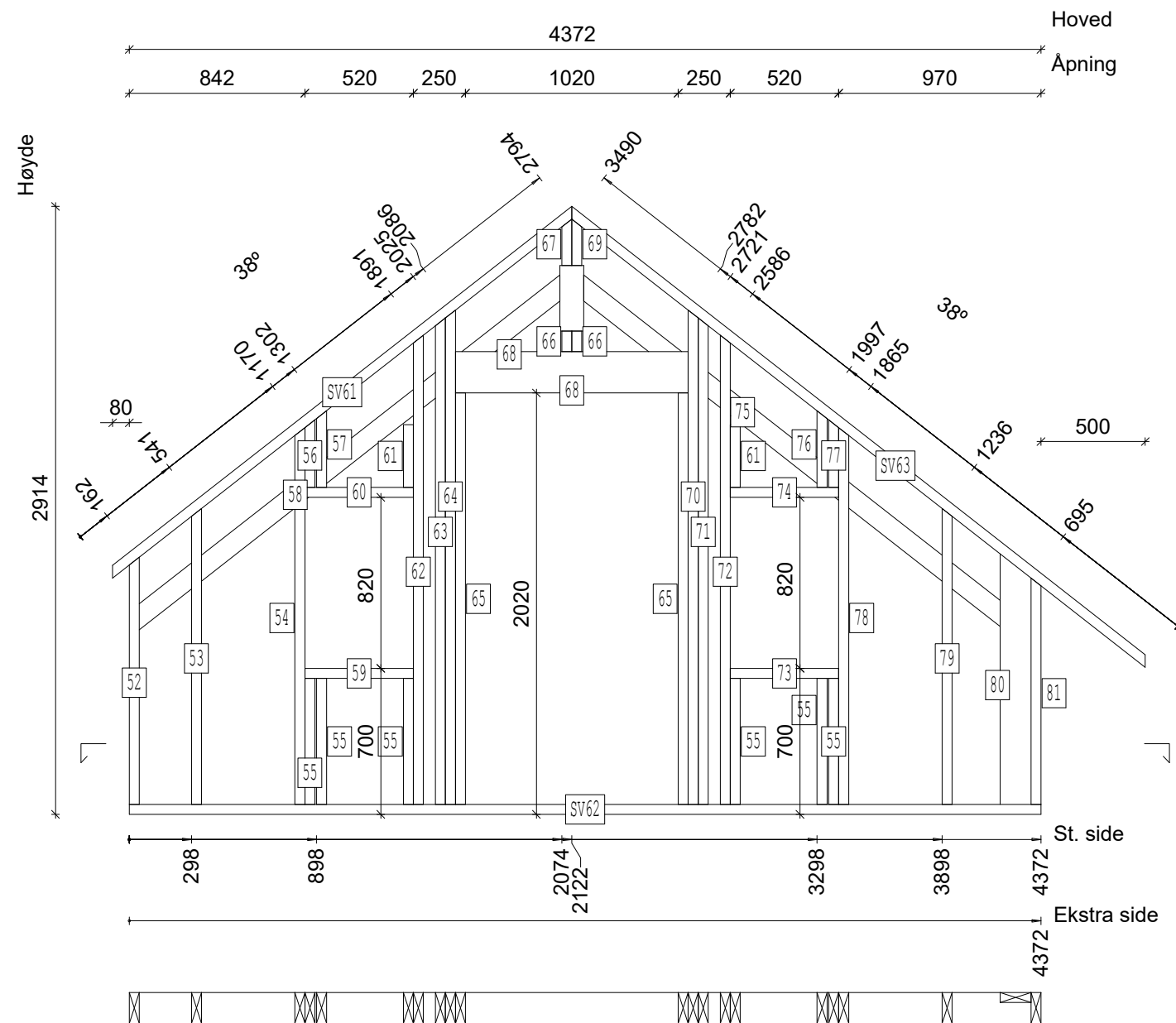

KAPPELISTE				
LABEL	ANT	MATERIAL	TYPE	LENGDE
52	1	48x148 C24	STENDER	1185
53	1	48x148 C24	STENDER	1418
54	1	48x148 C24	STENDER	1805
55	6	48x148 C24	STENDER	604
56	1	48x148 C24	STENDER	323
57	1	48x148 C24	STENDER	367
58	1	23x98 C24	SPIKERSLAG	2696
59	1	48x148 C24	LOSHOLT	520
60	1	48x148 C24	LOSHOLT	520
61	2	48x148 C24	STENDER	300
62	1	48x148 C24	STENDER	2249
63	1	48x148 C24	STENDER	2332
64	1	48x148 C24	STENDER	2369
65	2	48x148 C24	KRYKKE	1972
66	2	48x148 C24	STENDER	99
67	1	48x148 C24	STENDER	222
68	2	48x198 C24	LOSHOLT	1116
69	1	48x148 C24	STENDER	222
70	1	48x148 C24	STENDER	2369
71	1	48x148 C24	STENDER	2332
72	1	48x148 C24	STENDER	2249
73	1	48x148 C24	LOSHOLT	520
74	1	48x148 C24	LOSHOLT	520
75	1	23x98 C24	SPIKERSLAG	2610
76	1	48x148 C24	STENDER	367
77	1	48x148 C24	STENDER	323
78	1	48x148 C24	STENDER	1805
79	1	48x148 C24	STENDER	1418
80	1	48x148 C24	STENDER	1201
81	1	48x148 C24	STENDER	1085

SVILLER				
LABEL	ANT	MATERIAL	TYPE	LENGDE
SV61	1	48x148 C16	TOPPSVILL	2832
SV62	1	48x148 C16	BUNNSVILL	4372
SV63	1	48x148 C16	TOPPSVILL	3527